

EXPLANATORY NOTE

BY-LAW NO. 2007-129

A By-law to amend By-law 177-96, as amended.

Brawley Manor Corporation Part of Lots 16 and 17, Concession 7

The proposed by-law amendment applies to a 4.3 ha. (10.6 acres) parcel of land located east of Mingay Avenue, south of Monkhouse Road.

The lands are presently zoned Agriculture (A1) by By-law 304-87, as amended.

The purpose of the by-law amendment is to incorporate the lands into the designated area of By-law 177-96, as amended and to zone them Residential Two (R2*99) Zone.

The effect of the by-law amendment will be to permit the lands to be developed for residential purposes.

Q:\Development\Planning\APPL\SUBDIV\02 115478 Brawley Manor Phase 2B\BYLAWEXPLANNOTE177-96bmph6.doc



BY-LAW 2007-129

A by-law to amend Urban Expansion Area
Zoning By-law 177-96, as amended
(To incorporate lands into the designated area of this By-law)

THE COUNCIL OF THE CORPORATION OF THE TOWN OF MARKHAM
HEREBY ENACTS AS FOLLOWS:

1. THAT By-law 177-96, as amended, is hereby further amended as follows:
 - 1.1 By expanding the designated area of By-law 177-96 to include the lands in Lots 16 and 17, Concession 7, as shown on Schedule 'A' attached hereto.
 - 1.2 By zoning the lands

Residential Two (R2*99) Zone

as shown on Schedule 'A' attached hereto.
2. All other provisions of By-law 177-96, as amended, not inconsistent with the provisions of this by-law shall continue to apply.

READ A FIRST, SECOND, AND THIRD TIME AND PASSED THIS
12TH DAY OF JUNE, 2007.



KIMBERLEY KITTERINGHAM
DEPUTY TOWN CLERK

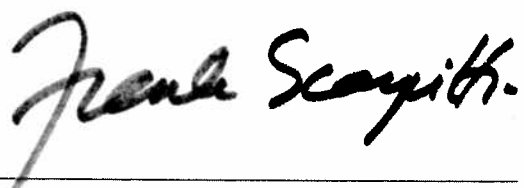

FRANK SCARPITTI
MAYOR

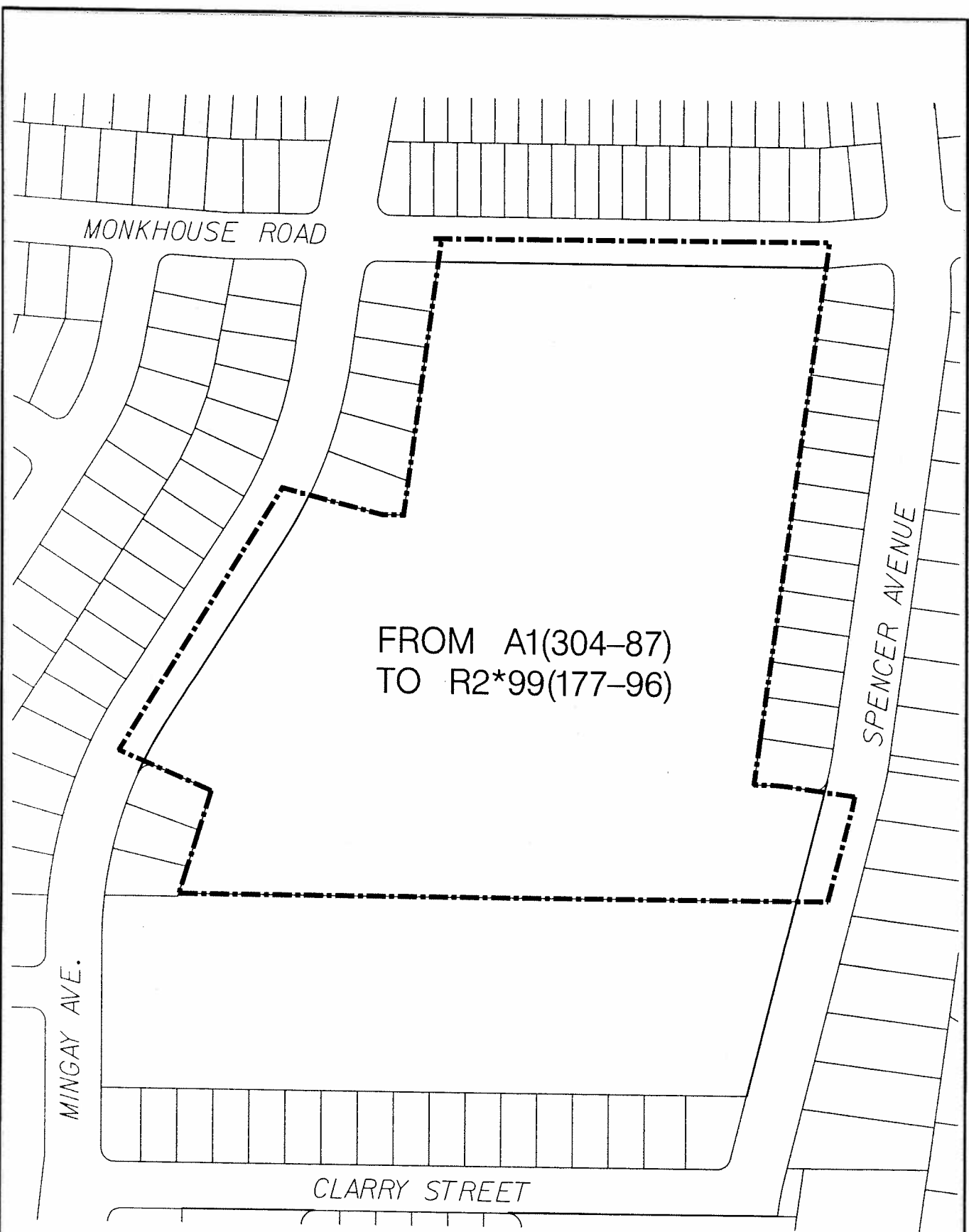

DEVELOPMENT SERVICES COMMISSION

A BY-LAW TO AMEND BY-LAW 177-96

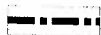

BOUNDARY OF AREA COVERED BY THIS BY-LAW

☒ R2 RESIDENTIAL TWO

☐ A1 AGRICULTURE ONE

☒ (No) EXCEPTION NUMBER

THIS IS SCHEDULE 'A' TO BY-LAW 2007-129
PASSED THIS 12TH DAY JUNE, 2007

Frank Scarpitta MAYOR
[Signature] DEPUTY CLERK

NOTE: 1) DIMENSIONS ARE IN METRES
2) REFERENCE SHOULD BE MADE TO
THE ORIGINAL BY-LAW LODGED IN
THE OFFICE OF THE CLERK

SCALE 1: 2000