

EXPLANATORY NOTE:

**By-law No: 2010-47**

A By-law to amend By-law 122-72, as amended.

34 Main Street South, Unionville  
Part of Lot 9, Concession 5  
Markham Centre

LANDS AFFECTED

This proposed By-law amendment applies to a 1.41 hectare (3.5 acres) parcel of land municipally known as 34 Main Street South, Unionville, Markham Centre.

EXISTING ZONING

The lands are zoned Rural Residential One (RR1) under BY-law 122-72, as amended. The subject lands are to be deleted from the designated area of By-law 122-72, as amended.

PURPOSE AND EFFECT OF THIS BY-LAW

The purpose of this By-law amendment is to delete the subject lands from the designated area of By-law 122-72, as amended. The subject lands will be incorporated within the designated area of By-law 2004-196, as amended, and zoned MC-D2 \*8(H), MC-D2\*9(H), and MC-PS2.

The effect of this By-law is to permit the development of the subject lands for three retirement apartment buildings.

---



## BY-LAW 2010-47

A by-law to amend By-law 122-72, as amended

THE COUNCIL OF THE CORPORATION OF THE TOWN OF MARKHAM  
HEREBY ENACTS AS FOLLOWS:

1. By-law 122-72, as amended, is hereby further amended, by deleting the lands identified as Part of Lot 9, Concession 5, as shown on Schedule 'A' attached hereto from the designated area of By-law 122-72, as amended.
2. This By-law shall not come into effect until By-law 2010-48 amending By-law 2004-196, as amended, comes into effect, and the lands as shown on Schedule 'A' attached hereto, are incorporated into the designated area of By-law 2004-196, as amended.
3. All other provisions of By-law 122-72, as amended, not inconsistent with the provisions of this By-law, shall continue to apply.

READ A FIRST, SECOND, AND THIRD TIME AND PASSED THIS  
24<sup>TH</sup> DAY OF MARCH, 2010.

KIMBERLEY KITTERINGHAM  
TOWN CLERK

FRANK SCARPITTI  
MAYOR

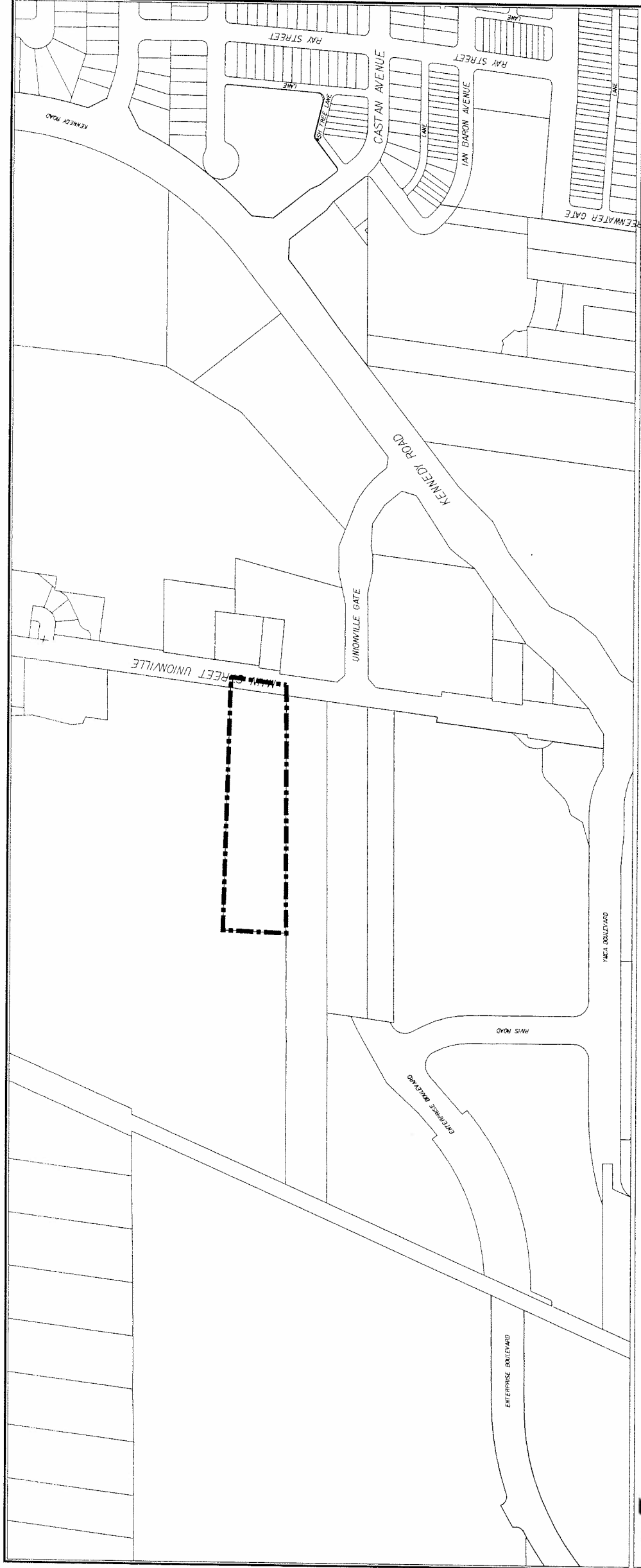

DEVELOPMENT SERVICES COMMISSION

A BY-LAW TO AMEND BY-LAW

122-72

THIS IS SCHEDULE 'A' TO BY-LAW 2016-47  
PASSED THIS 24<sup>TH</sup> DAY MARCH, 2010.

*John Smith* MAYOR  
*[Signature]* CLERK

BOUNDARY OF AREA COVERED BY THIS BY-LAW



NOTE: 1) DIMENSIONS ARE IN METRES  
2) REFERENCE SHOULD BE MADE TO  
THE ORIGINAL BY-LAW LODGED IN  
THE OFFICE OF THE CLERK

SCALE 1: 6000