

EXPLANATORY NOTE

BY-LAW NO. 2010-189

A By-law to amend By-law 165-80, as amended

St. Maurice and St. Verena Coptic Orthodox Church
1050 Rodick Road (northwest corner of Highway 7 and Rodick Road)

LANDS AFFECTED

This by-law applies to a vacant 1.2 hectare (3 acre) property located at the northwest corner of Highway 7 and Rodick Road.

EXISTING ZONING

The subject property is zoned “Select Industrial and Limited Commercial” [M.C.(150%)] by By-law 165-80, as amended. This zoning permits industrial and office uses.

PURPOSE AND EFFECT

The purpose and effect of this by-law is to delete the subject property from the designated area of By-law 165-80, as amended. The property will be incorporated by a subsequent by-law into the designated area of By-law 2004-196 and zoned “Markham Centre – Downtown Two” (MC-D2) in order to permit the property to be developed with a place of worship.



BY-LAW 2010-189

A By-law to amend By-law 165-80, as amended

THE COUNCIL OF THE CORPORATION OF THE TOWN OF MARKHAM HEREBY ENACTS AS FOLLOWS:

1. By-law 165-80, as amended, is hereby further amended by deleting the lands identified as Part of Lot 11, Concession 4 as shown on Schedule 'A' attached hereto from the designated area of By-law 165-80, as amended.
2. This By-law shall not come into effect until By-law 2010-190 amending By-law 2004-196, as amended, comes into effect, and the lands as shown on Schedule 'A' attached hereto, are incorporated into the designated area of By-law 2004-196, as amended.
3. All other provisions of By-law 165-80, as amended, not inconsistent with the provisions of this By-law shall continue to apply.

READ A FIRST, SECOND, AND THIRD TIME AND PASSED THIS
21ST DAY OF SEPTEMBER, 2010.

KIMBERLEY KITTERINGHAM
TOWN CLERK

FRANK SCARPITTI
MAYOR

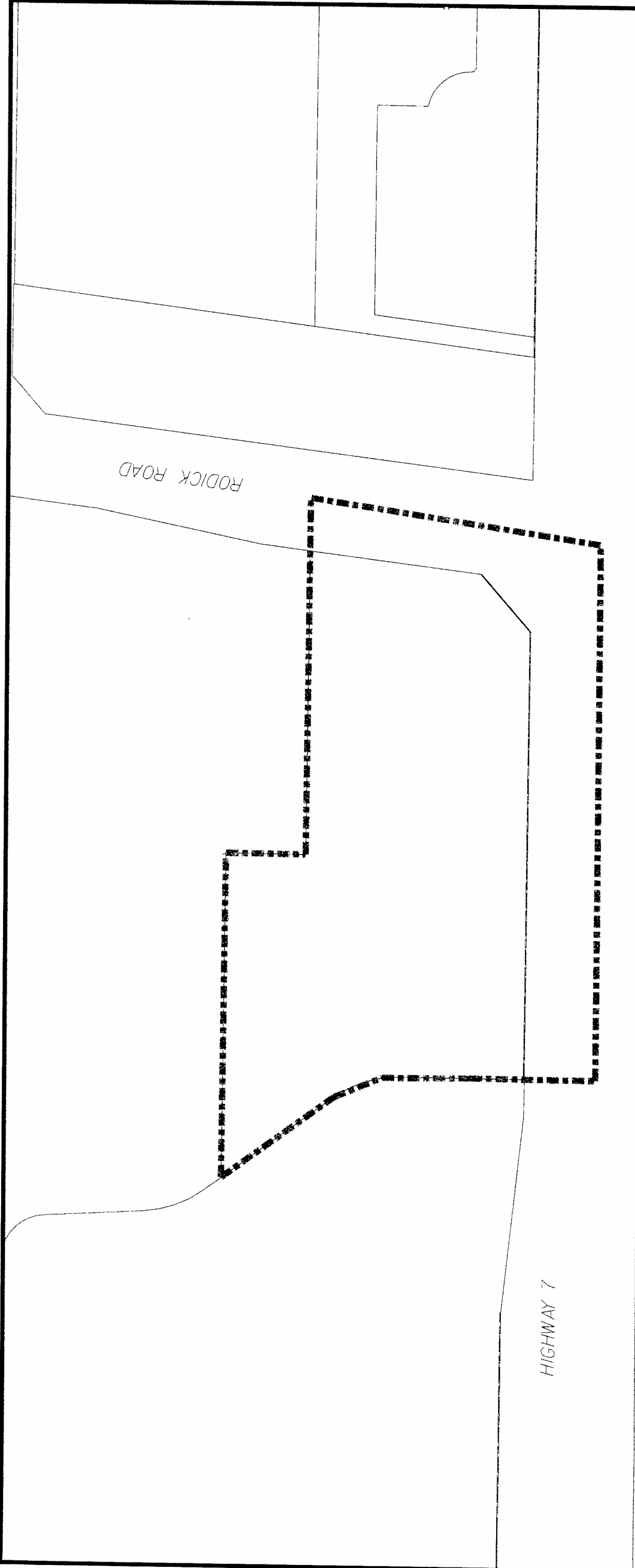

DEVELOPMENT SERVICES COMMISSION

THIS IS SCHEDULE 'A' TO BY-LAW 2010-189
PASSED THIS 21ST DAY SEPT., 2010.

John Scapellato
MAYOR

[Signature]
CLERK

A BY-LAW TO AMEND BY-LAW 165-80

BOUNDARY OF AREA COVERED BY THIS BY-LAW



NOTE: 1) DIMENSIONS ARE IN METRES
2) REFERENCE SHOULD BE MADE TO
THE ORIGINAL BY-LAW LODGED IN
THE OFFICE OF THE CLERK

SCALE 1: