

TIMES GROUP - MARKHAM UPTOWN PHASING PLAN

FLASKA DITCH TO BE PIPED & RELOCATED TO STREET 'A' R.O.W. WHEN BLOCK 19 (SWM) IS REQUIRED OR STREET 'C' SERVICES CONSTRUCTED

- 1) SANITARY SEWER AND WATER MAIN FROM HIGHWAY 7, SOUTH ON STREET 'B' THEN WEST ON STREET 'C'
- 2) SWM - EAST PORTION OF SITE (PHASES 1 AND 2) DRAINS TO BLOCK 20 - SWM BLOCK
- 3) SWM - WEST PORTION OF SITE (FUTURE PHASES) DRAINS TO BLOCK 19 - SWM BLOCK
- 4) MDE - FROM THE SOUTH, NORTH ON STREET 'B' THEN WEST ON STREET 'C'; TEMPORARY FACILITY ON BLOCKS 7 AND 8 IF REQUIRED (FOR BLOCK 6)

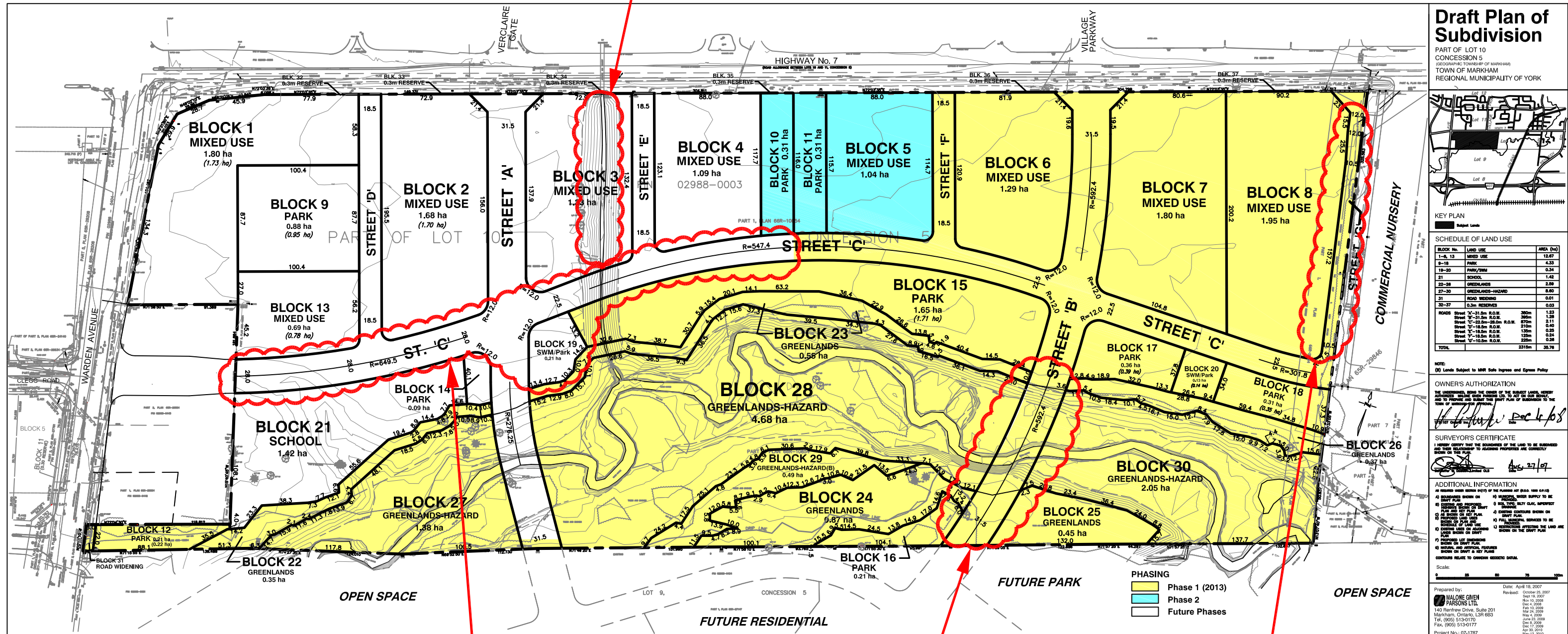

TRANSPORTATION AND SERVICING INTRASTRUCTURE FOR FUTURE PHASES TO BE DETERMINED TO THE SATISFACTION OF THE TOWN

TIMING OF WEST HALF OF STREET 'C' MAY BE ADVANCED, IF REQUIRED, BY SCHOOL BOARD REQUEST

BIRCHMOUNT (STREET 'B') BRIDGE CONSTRUCTION BY THE TOWN OF MARKHAM

TIMING OF STREET 'C' SUBJECT TO AGREEMENT BETWEEN TIMES, SHERIDAN AND TOWN