



Corporate Services Commission

Event Code:2012-097

COMMUNITY EVENT – WORK ORDER ROAD USE NOTIFICATION

Event Name: Kids Sports Day in Markham

ORGANIZATION INFORMATION

Name: Meg Stokes
Title: National Program Director
Host Organization: City of Markham
Address:
City, Province
Postal Code

Day Tel: 905-477-7743
Eve Tel:
Cell Tel:
Fax:
Email:
Web:

ROAD USE CONTACT INFORMATION

Day Prior: Meg Stokes

Phone number: 905-477-7743

Day of Event: Lori Wells

Cell number:

ROADS INVOLVED

List the street(s) and/or roads affected and proposed closures from start to finish route.

This event will utilize the following roads:

- Main Street Unionville south & south of Enterprise

Date, time and location of the event

Road Use/Closure Start Date:September 29, 2012

Road Use/Closure End Date:September 29, 2012

Road Use/Closure Set-up Time: 6:00 am

Road Use/Closure Tear Down Time: 6:00 pm

Road Use/Closure Start Time: 7:00 am

Road use End Time: 5:00 pm

Event Location: Main street South – South of Enterprise

ALTERNATE ROUTE

BARRICADE(S) DROP OFF LOCATION(S) & QUANTITY

- 2 @ south of Enterprise Blvd
- 4 @ Enterprise Blvd & East of Ravis Rd
- 2 @ Main Street South

“ROAD CLOSED AHEAD” SIGNAGE – LOCATION(S)

1. Hwy 7 & Main Street Unionville
2. Birchmount Rd & Enterprise Blvd

ROAD CLOSED SIGNAGE

1. Main Street Unionville
2. Enterprise Blvd

MUNICIPAL PARKING LOTS INVOLVED

Use of Municipal Parking Lot

Brother Crothers

Parking Lot Location:

Time of Use

PARKING / TRAFFIC & TRANSPORTATION CONTROL PLAN

Participant & Guest Parking Plan:

PYLONS & SAFETY VESTS

Quantity required:

Pylons:

10

Vests:

REGIONAL & PROVINCIAL ROADS

Use of regional or provincial roads:

No

APPROVAL LEVELS

- 1) Road use that is contained to Town of Markham roadways requires approval from the following group(s):
 - Clerks Department
 - Road use is contained within a specified area in which there is a minimum number of homes involves
 - Council Approval
 - Main traffic is interrupted
- 2) Road Use that occurs within the right-of-way of a regional road requires:
 - York Region Transportation & Works Department Permit
- 3) Road Use that occurs within the right-of-way of a provincial road:
 - Ministry of Transportation / Road Work Scheduling & Coordination Unit

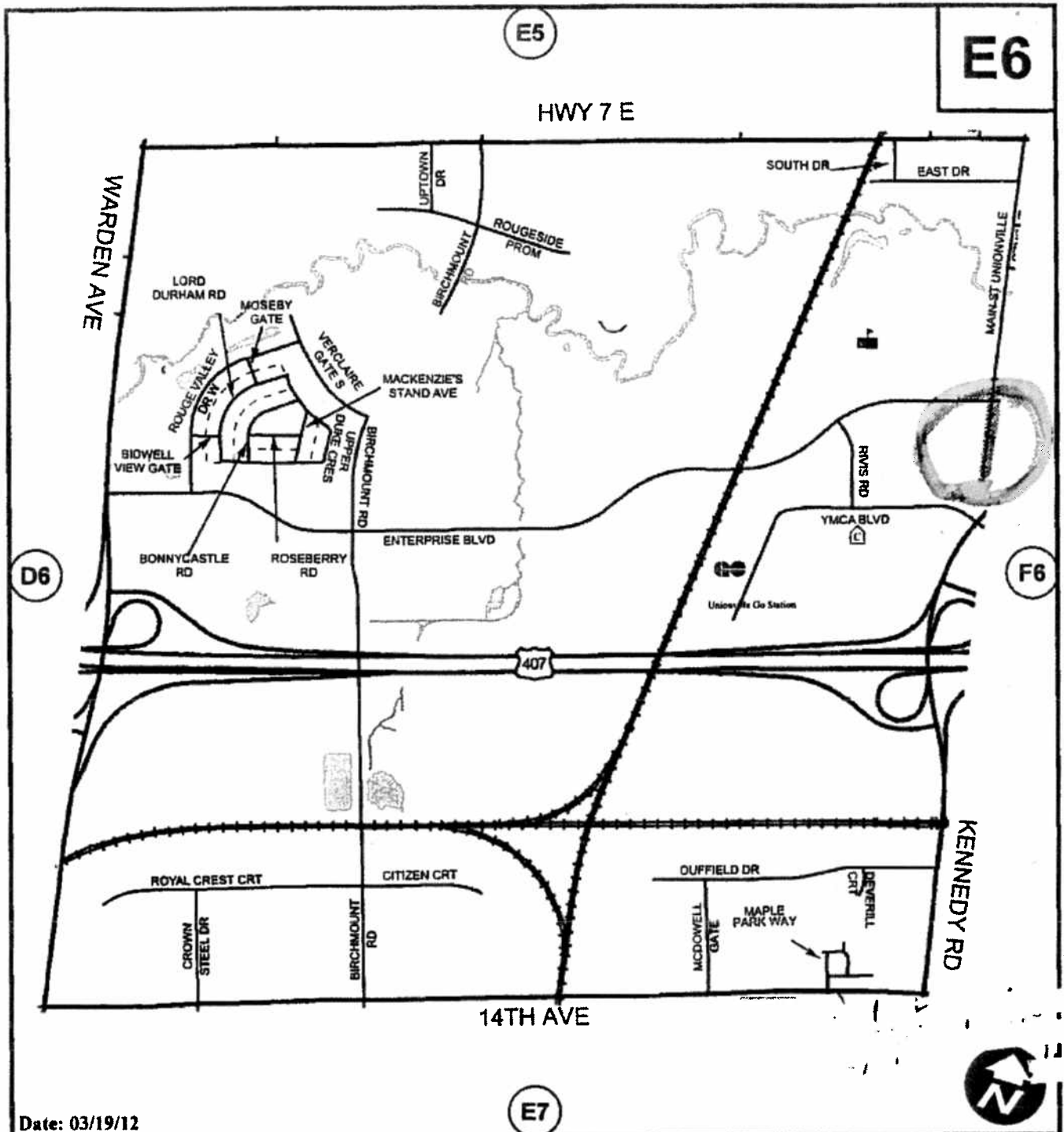

Date: 03/19/12



- | | | |
|--------------------|-------------------|-------------|
| GO Transit Station | Place Of Worship | Local Roads |
| Ambulance Station | Community Centre | Laneway |
| Fire Station | School | Major Roads |
| Police Station | Library | Highways |
| Hospital | Park / Open Space | Railways |
| Airport | | Watercourse |

