



Explanatory Note

By-law 2014-89

A By-law to amend By-laws 177-96, as amended

1473092 Ontario Ltd.

Metrus Development

Concession 9, Part of Lots 16 and 17, Draft Plan 19TM-01015 (Phase 6)

Cornell Planning District

Lands Affected

The proposed by-law amendment applies to 16.1 acres (6.5 ha) of lands located south of Donald Cousens Parkway, east of 9th Line, within the Cornell community.

Existing Zoning

The lands subject to this proposed By-law amendment are presently zoned Residential Two*190*210*344 (Holding One), R2*190*210*344*408 and Residential Two*190*210*388 (Holding One) under By-law 177-96

Purpose and Effect

The purpose and effect of this By-law is to remove the hold provisions on the property to permit the construction of 85 singles and 73 townhouses.

The conditions of the holding provision have been met as follows:

- Council has confirmed that there is sufficient servicing capacity for the lands
- Trustee for the Cornell Developers Group Cost Sharing Agreement has confirmed servicing allocation



BY-LAW 2014-89

A By-law to amend By-law 177-96, as amended

THE COUNCIL OF THE CORPORATION OF THE CITY OF MARKHAM
HEREBY ENACTS AS FOLLOWS:

1 By-law 177-96, as amended, is hereby further amended as follows:

1.1 By rezoning the lands from:

- i) Residential Two*190*210*344 (Holding One) to
Residential Two*190*210*344;
- ii) Residential Two*190*210*344*408 (Holding One) to
Residential Two*190*210*344*408; and
- iii) Residential Two*190*210*388 (Holding One) to
Residential Two*190*210*388

as shown on Schedule 'A' attached hereto.

2 All other provisions of By-law 177-96, as amended, not inconsistent with the
provisions of this By-law shall continue to apply.

Read a first, second, and third time and passed on June 24, 2014.



Kimberley Kitteringham
City Clerk

Frank Scarpitti
Mayor

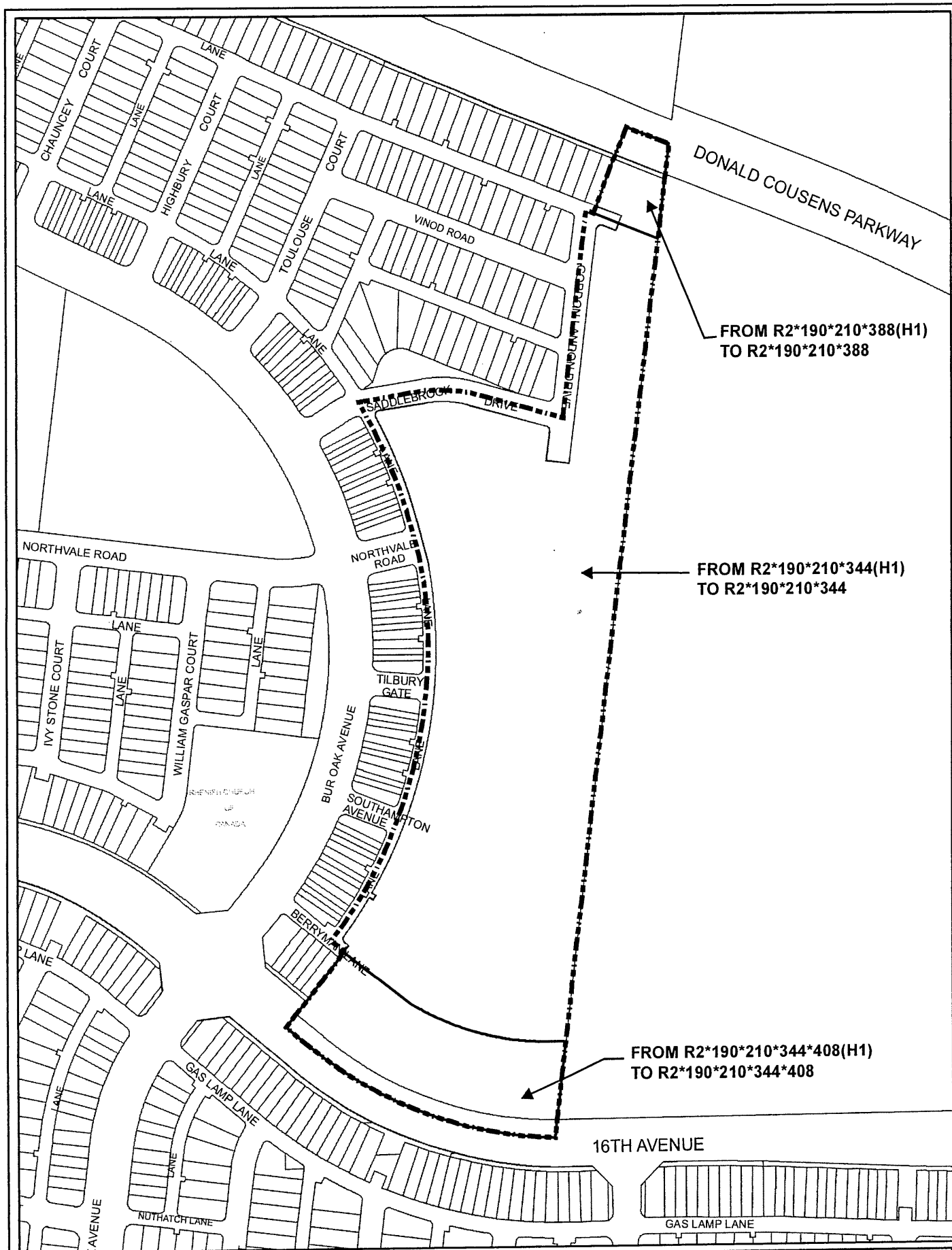

BY-LAW SCHEDULE 'A' TO BY-LAW 2014-89 **AMENDING BY-LAW 177-96 DATED June 24, 2014**

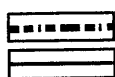

BOUNDARY OF AREA COVERED BY THIS BY-LAW SCHEDULE

BOUNDARY OF ZONE DESIGNATION(S)

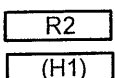

RESIDENTIAL TWO

HOLDING PROVISION

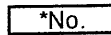

EXCEPTION SECTION NUMBER

Q:\Geomatics\New Operation\By-Laws\ZA\ZA14115927\ZA14115927.mxd



DEVELOPMENT SERVICES COMMISSION

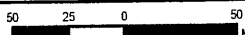

Drawn By: CPW

Checked By: TK

DATE: 05/06/2014

NOTE: This Schedule should be read in conjunction with the signed original By-Law filed with the City of Markham Clerk's Office