

SCHEDULE " A " TO BY-LAW 177-96

AMENDING BY-LAW

DATED



BOUNDARY OF AREA COVERED BY THIS SCHEDULE

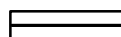

BOUNDARY OF ZONE DESIGNATION(S)

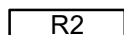

Residential Two Zone

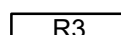

Residential Three Zone



Community Amenity One Zone

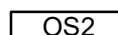

Open Space Two Zone

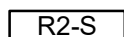

Residential Two - Special Zone



Residential Four Zone



Open Space One Zone

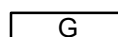

Greenway Zone

THIS IS NOT A PLAN OF SURVEY. Zoning information presented in this Schedule is a representation sourced from Geographic Information Systems. In the event of a discrepancy between the zoning information contained on this Schedule and the text of zoning by-law, the information contained in the text of the zoning by-law of the municipality shall be deemed accurate.

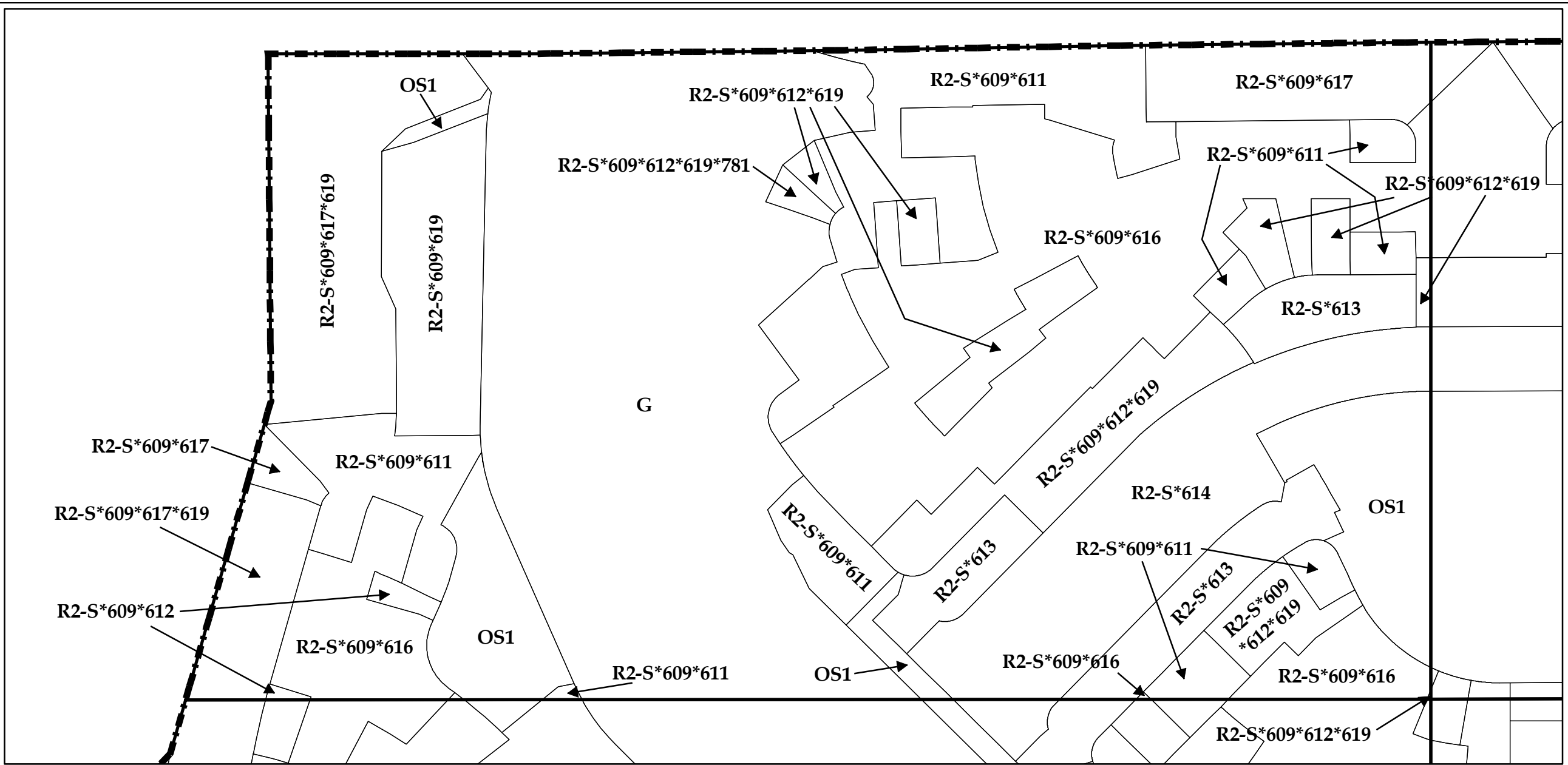

SCHEDULE " A-1 " TO BY-LAW 177-96

AMENDING BY-LAW DATED

THIS IS NOT A PLAN OF SURVEY. Zoning information presented in this Schedule is a representation sourced from Geographic Information Systems. In the event of a discrepancy between the zoning information contained on this Schedule and the text of zoning by-law, the information contained in the text of the zoning by-law of the municipality shall be deemed accurate.

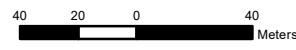

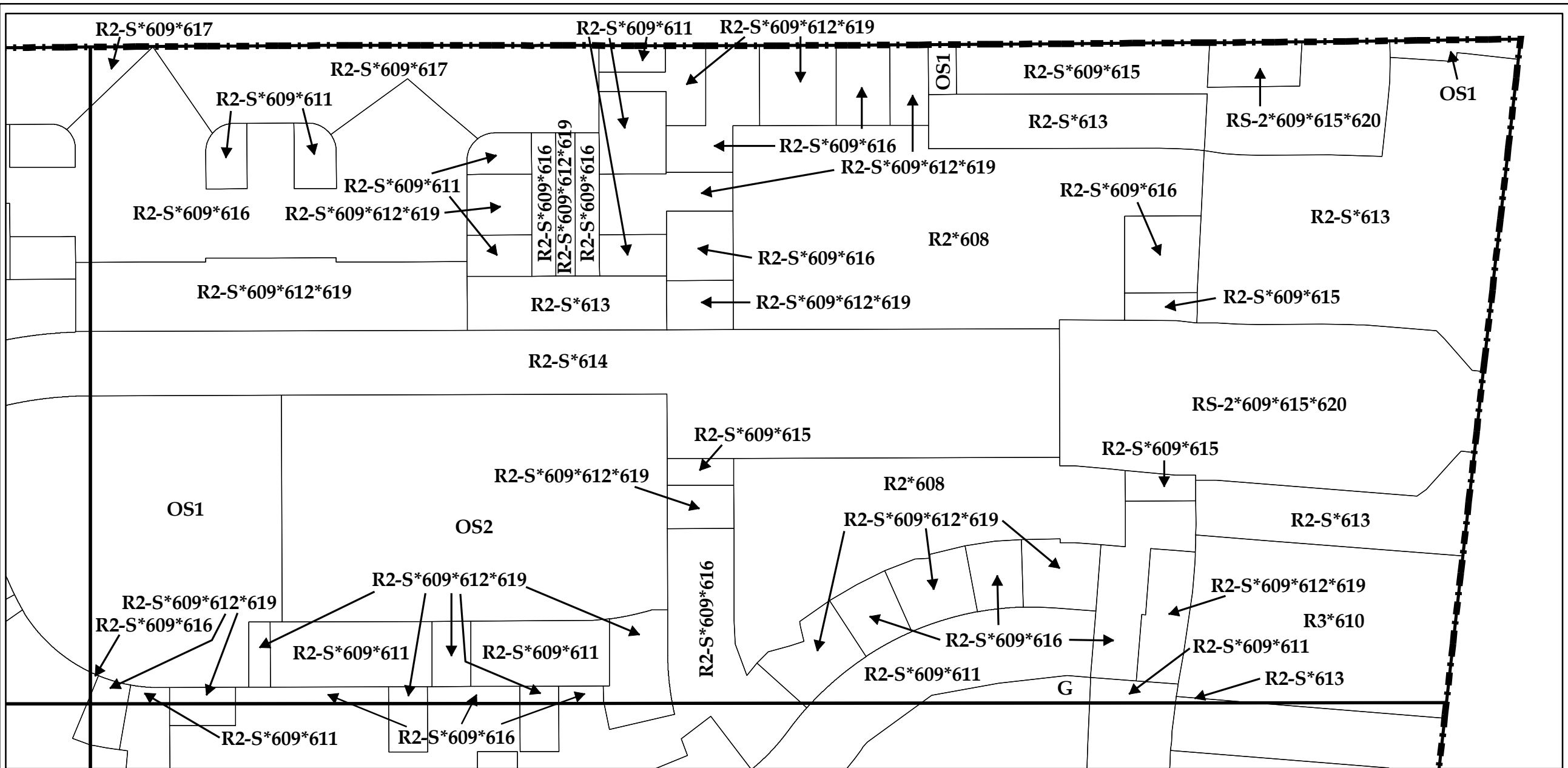

SCHEDULE " A-2 " TO BY-LAW 177-96

AMENDING BY-LAW DATED

THIS IS NOT A PLAN OF SURVEY. Zoning information presented in this Schedule is a representation sourced from Geographic Information Systems. In the event of a discrepancy between the zoning information contained on this Schedule and the text of zoning by-law, the information contained in the text of the zoning by-law of the municipality shall be deemed accurate.



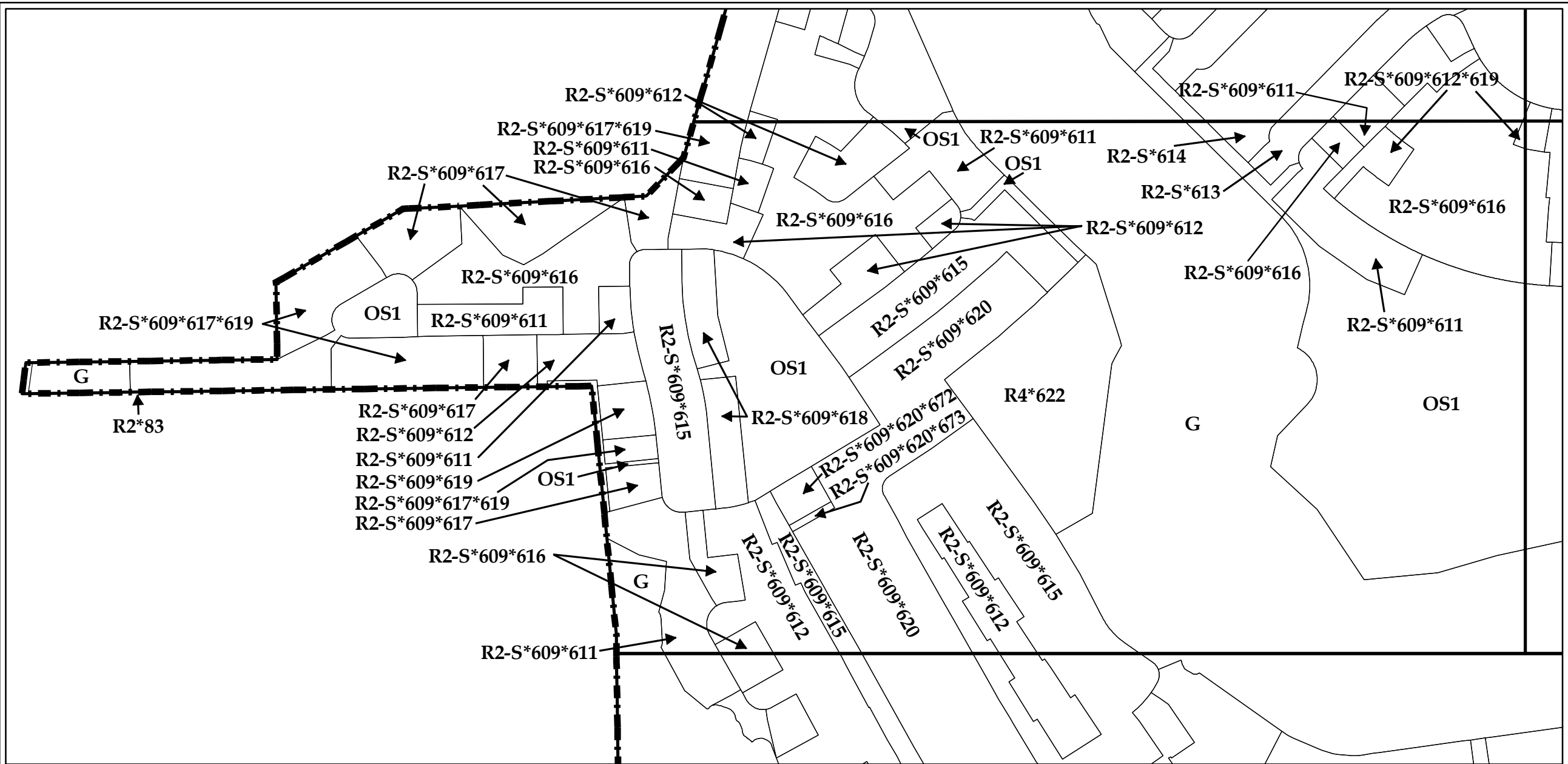

SCHEDULE "A-3" TO BY-LAW 177-96

AMENDING BY-LAW DATED

THIS IS NOT A PLAN OF SURVEY. Zoning information presented in this Schedule is a representation sourced from Geographic Information Systems. In the event of a discrepancy between the zoning information contained on this Schedule and the text of zoning by-law, the information contained in the text of the zoning by-law of the municipality shall be deemed accurate.

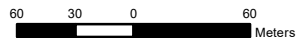

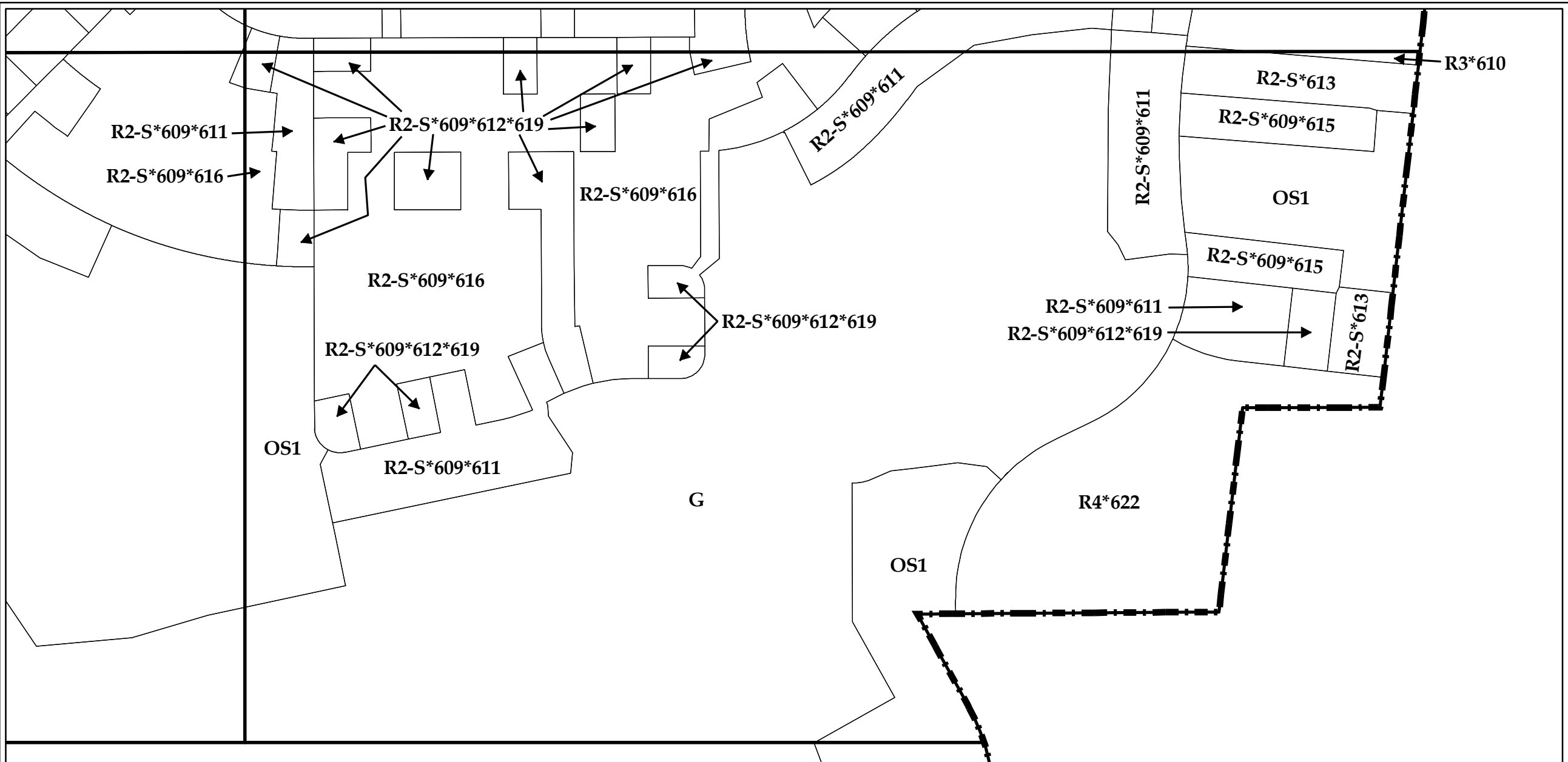

SCHEDULE " A-4 " TO BY-LAW 177-96

AMENDING BY-LAW

DATED

THIS IS NOT A PLAN OF SURVEY. Zoning information presented in this Schedule is a representation sourced from Geographic Information Systems. In the event of a discrepancy between the zoning information contained on this Schedule and the text of zoning by-law, the information contained in the text of the zoning by-law of the municipality shall be deemed accurate.

