



Alcohol and Gaming Commission of Ontario
 90 Sheppard Avenue East, Suite 200
 Toronto ON M2N 0A4
 Tel.: 416-326-8700 • Fax: 416-326-8711
 Toll free in Ontario: 1-800-522-2876
 Inquiries: www.agco.ca/iagco
 Website: www.agco.ca

Municipal Information for Liquor Sales Licences

The information requested below is required in support of all applications for a new Liquor Sales Licence or outdoor areas being added to an existing Liquor Sales Licence.

Section 1 – Application Details

Premises Name

Espresso 21

Premises Phone Number (include area code)

3656083788

Premises Address

159E Main St Unionville

City/Town

Unionville

Province

ON

Postal Code

L3R2G8

Contact Name

Kit Chau

Contact's Phone Number (include area code and extension)

4166279248

Contact's Email Address

espressoxxi21@gmail.com

Does the application for a Liquor Sales Licence include indoor areas and/or outdoor areas?

Indoor Areas Outdoor Areas

Section 2 – Municipal Clerk's Official Notice of Application for a Liquor Sales Licence in your Municipality.

Municipal Clerk:

Please confirm the "wet/damp/dry" status below.

Name of village, town, township or city where taxes are paid.

(If the area where the establishment is located was annexed or amalgamated, provide the name that the village, town, township or city was known as.)

Markham

Is the area where the establishment is located "wet", "damp" or "dry"? Please select one.

Wet (for spirits, beer, wine) Damp (for beer and wine only) Dry

Note: Specific concerns regarding zoning or non-compliance with by-laws must be clearly outlined in a separate submission or letter within 30 days of this notification.

Address of Municipal Office

Date (dd/mm/yyyy)

Title

Signature of Municipal Official



Liquor Licence Questionnaire

The Corporation of the City of Markham

To evaluate your Liquor Licence Application, you are required to complete this Questionnaire.

Submit the all required documentation to the Clerk's Office by mail or in-person to the address below.

City of Markham
Clerk's Office
Legislative Services Department
101 Town Centre Boulevard
Markham, Ontario
L3R 9W3

Attention: Public Services Assistant

If you have any questions about this Questionnaire, please call 905-477-7000 ext. 2366.

Liquor Licence Questionnaire Checklist

The following items **must** be submitted with this completed Questionnaire to the Clerk's Office:

- ✓ Applicable fee;
- ✓ A sample menu; and,
- ✓ Copy of the floor plan showing the layout, areas that require licensing, seating arrangements, washrooms (show fixtures) and exits.

Applicant Contact Information

First Name KIT		Last Name CHAU	
Street Number 159E	Street Name main street		Suite/Unit Number
City Unionville		Postal Code L3R 2G8	Province On
Telephone Number 365 608 3788	Mobile Number 416 627 9248	Email	

Restaurant Information

Name of Restaurant ESPRESSO 21			
Street Number 159E	Street Name main street		Suite/Unit Number
City Unionville		Postal Code L3R 2G8	Province ON

What is the closest major intersection to the restaurant? HWY 7	What is the distance between the restaurant and the closest residential area? (in kilometres) 10 kilometres
Does the restaurant have a valid Business Licence issued by the City of Markham? <input checked="" type="radio"/> Yes <input type="radio"/> No Business Licence Number: <u>24 157148 EE</u> If no, please note that a Business Licence is required.	Does the restaurant have a working Fire Alarm System? <input checked="" type="radio"/> Yes <input type="radio"/> No
Type of restaurant (select one) <input type="checkbox"/> Family <input type="checkbox"/> Roadhouse <input type="checkbox"/> Sports Bar <input type="checkbox"/> Fine Dining <input type="checkbox"/> Take Out <input checked="" type="checkbox"/> Cafe	
What, if any, entertainment or amusements will be provided in the restaurant? (select all that apply) <input type="checkbox"/> Karaoke <input checked="" type="checkbox"/> Live Entertainment <input type="checkbox"/> Casino <input type="checkbox"/> Off-Track Betting <input type="checkbox"/> Arcade	
Is the liquor licence application for an expansion of the existing operations? <input checked="" type="radio"/> Yes <input type="radio"/> No If yes, please provide the <u>current</u> existing maximum seating capacity: <u>28</u> If no, please provide the <u>planned</u> existing maximum seating capacity: _____	
Location History	
Has a Building Permit been applied for or obtained for this location? <input type="radio"/> Yes Building Permit Number: _____ <input checked="" type="radio"/> No	
Was the location previously used as a restaurant? <input checked="" type="radio"/> Yes <input type="radio"/> No If no, a Building Permit is required. Contact Building Services at 905-477-7000 ext. 4870 for more information.	
If the location was previously used as a restaurant, has construction or alteration been proposed? <input type="radio"/> Yes <input checked="" type="radio"/> No If yes, please provide Alteration Permit Number: _____	

[Signature]
Applicant's Signature

Jan 31, 2024
Date

Information on this form is collected under the authority of Section 11 of the Municipal Act, 2001, S.O. 2001, c. 25, as amended and Section 12 of the Liquor Licence Act, R.S.O. 1990, Chapter L.19, as amended. The information you have provided will be used to contact you and process your Liquor Licence Application. If you have questions about this collection contact the Access & Privacy Manager, Legislative Services Development, 101 Town Centre Boulevard, Markham, Ontario, L3R 9W3, 905-477-5530.

ESPRESSO 21

Gallery & Cafe

Toast

1. Avocado Smoked Salmon toast **\$20**
Toasted black bread with avocado cream cheese, smoked salmon, cherry tomatoes and pomegranate
2. Avocado with egg toast **\$17**
Toasted black bread with avocado and eggs, cream cheese, tomatoes and pomegranate
3. Bacon & egg toast **\$20**

Eggs Benedict

1. Smoked Salmon eggs Benedict **\$19**
English muffin with poached eggs, cream cheese, arugula, smoked salmon and hollandaise sauce
2. Prosciutto eggs Benedict **\$19**
English muffin with poached eggs, mayo basil, iceberg, prosciutto and hollandaise sauce
3. Belly bacon eggs Benedict **\$18**
English muffin with poached eggs, mayo basil, iceberg, belly bacon and hollandaise sauce
4. Sausage eggs Benedict **\$19**

Salad

1. Caesar Salad **\$17**
2. Smoke salmon Salad **\$20**
3. Chicken salad **\$20**
4. Tuna Salad with egg **\$18**
5. Beef salad **\$19**

Panini

1. Prosciutto **\$19**
Prosciutto, iceberg, onion, Roman tomatoes, mayo basil and provolone cheese
2. Smoked Salmon **\$19**
Smoked salmon with arugula, cream cheese, Roman tomatoes and onion
3. Chicken and bacon **\$19**
Pesto chicken with crunchy bacon on iceberg, onion, sundries tomatoes, provolone cheese and mayo basil
4. Avocado tuna **\$19**
Smashed avocado with tuna on iceberg, onion, Roman tomatoes and mayo basil
5. Turkey panini **\$17**
Smoked turkey on iceberg, onion, Roman tomatoes and mayo basil
6. Roast beef panini **\$19**
Roast beef on iceberg, onion, Roman tomatoes and provolone cheese

Soup

1. Tomatoes **\$11**
Made with a base of veggies served with two slices of bread.
2. Tuscan bean soup **\$11**

Please inform us of any allergies!

ESPRESSO 21

Gallery & Cafe

Coffee

1. Espresso.	\$3.75
2. Americano.	\$4.25
3. Macchiato	\$4.5
4. Cortado	\$4.5
5. Cappuccino.	\$4.75
6. Flat white	\$4.75
7. Latte	\$5
8. Hot chocolate	\$5.5

More

1. Nutella Latte	\$6.5
2. Caramel latte	\$6
3. Mocha.	\$6
4. Spanish coffee.	\$6
5. Espresso tonic.	\$6
6. Maple latte.	\$6
7. Affogato (ice cream + coffee)	\$9.5
8. Irish coffee	\$9.5
9. Rosé cappuccino.	\$6.5

*Decaf avail

* Any hot & cold

* All one size

*option :

*oat almond soy coconut caramel \$1. *espresso \$2

*Flavor :vanilla .cinnamon .hazelnut. \$0.5

Tea

1.Hot tea.	\$3.75
2.ice tea .	\$4.5
3.matcha latte	\$5.75
4.London fog latte	\$5.75
5.chai latte.	\$5.75
6.lemon ice tea	\$6
7. peach tea.	\$6
8.lychee ice tea	\$6
9.passion fruit tea	\$6
10.mango ice tea	\$6

Lemonade sparkling. \$ 6

*Original *strawberry *mango

Ice Cream

Cup	\$6
Waffle.	\$6.5
Charcoal cone.	\$7.5

Cheesecake

Cheesecake	\$10.95
------------	---------

Please inform us of any allergies!

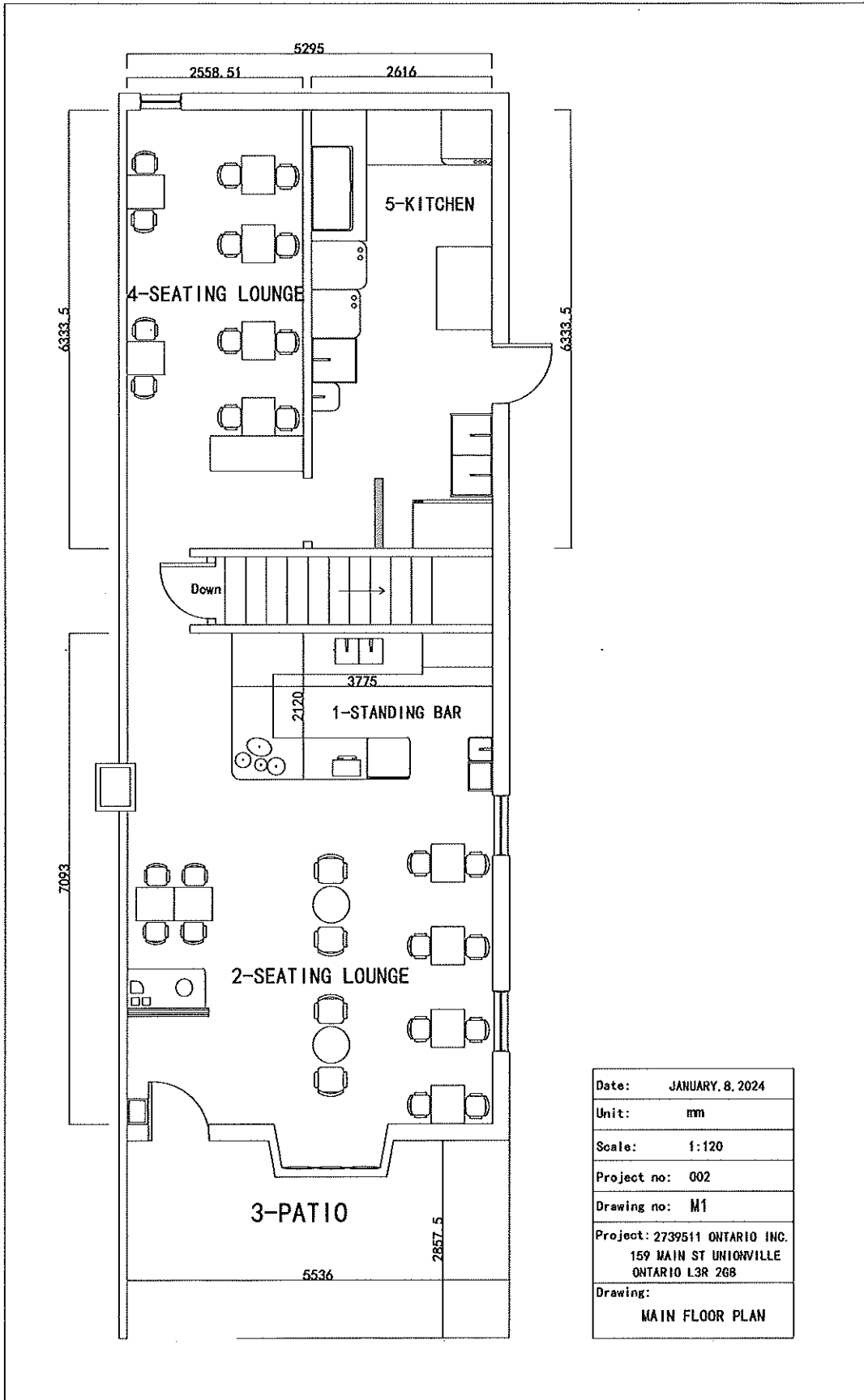

Date:	JANUARY, 8, 2024
Unit:	mm
Scale:	1:120
Project no:	002
Drawing no:	M1
Project:	2739511 ONTARIO INC. 159 MAIN ST UNIONVILLE ONTARIO L3R 2G8
Drawing:	MAIN FLOOR PLAN

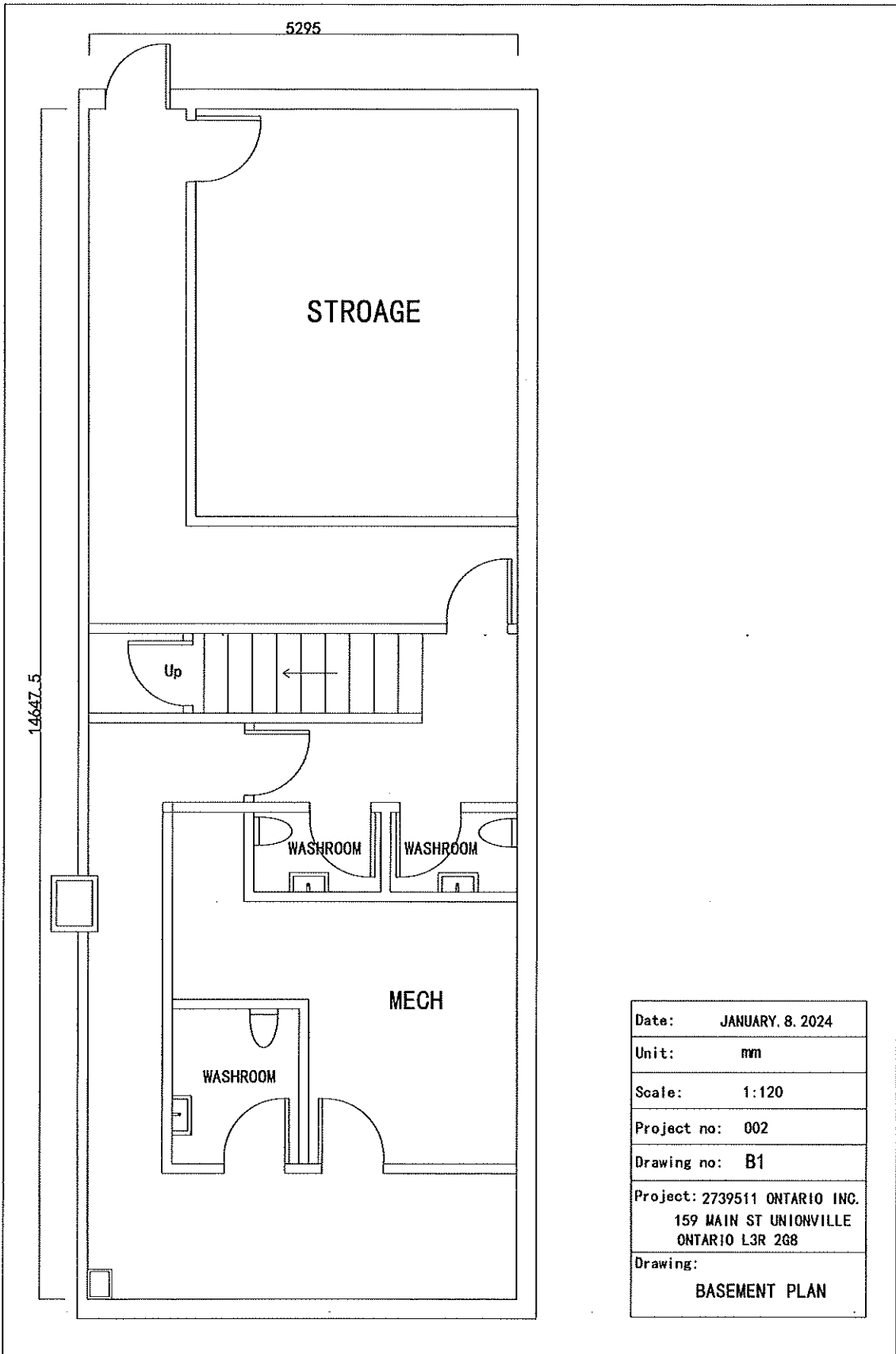

Date:	JANUARY, 8, 2024
Unit:	mm
Scale:	1:120
Project no:	002
Drawing no:	B1
Project:	2739511 ONTARIO INC. 159 MAIN ST UNIONVILLE ONTARIO L3R 2G8
Drawing:	BASEMENT PLAN