

Attachment “B” - Submitted Plans for Ice Rink and Cabana

Site Plan Drawing

- Existing House
- Existing Pool
- Proposed Cabana
- Proposed Sports Court/Ice Pad

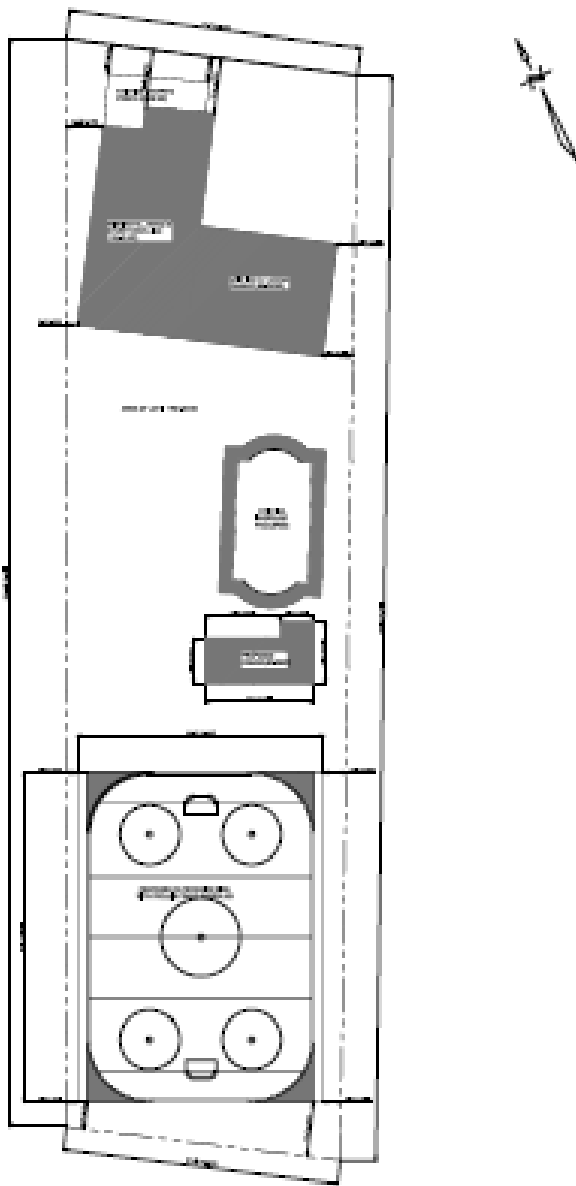

Enlargement of each section on the following pages

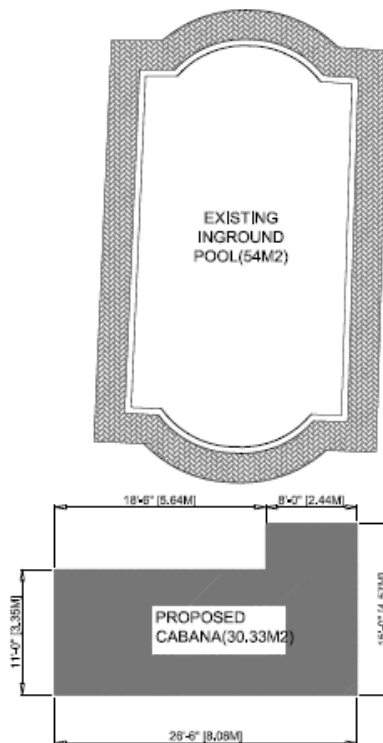
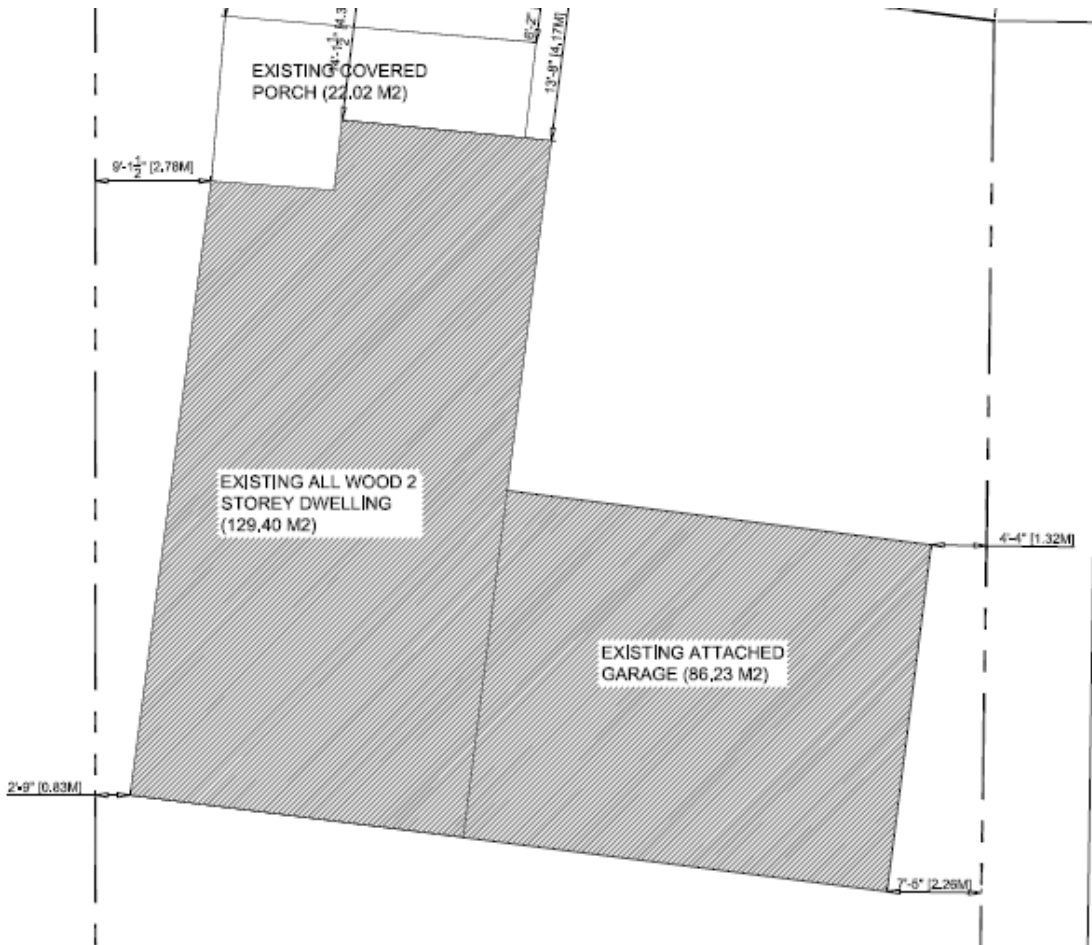

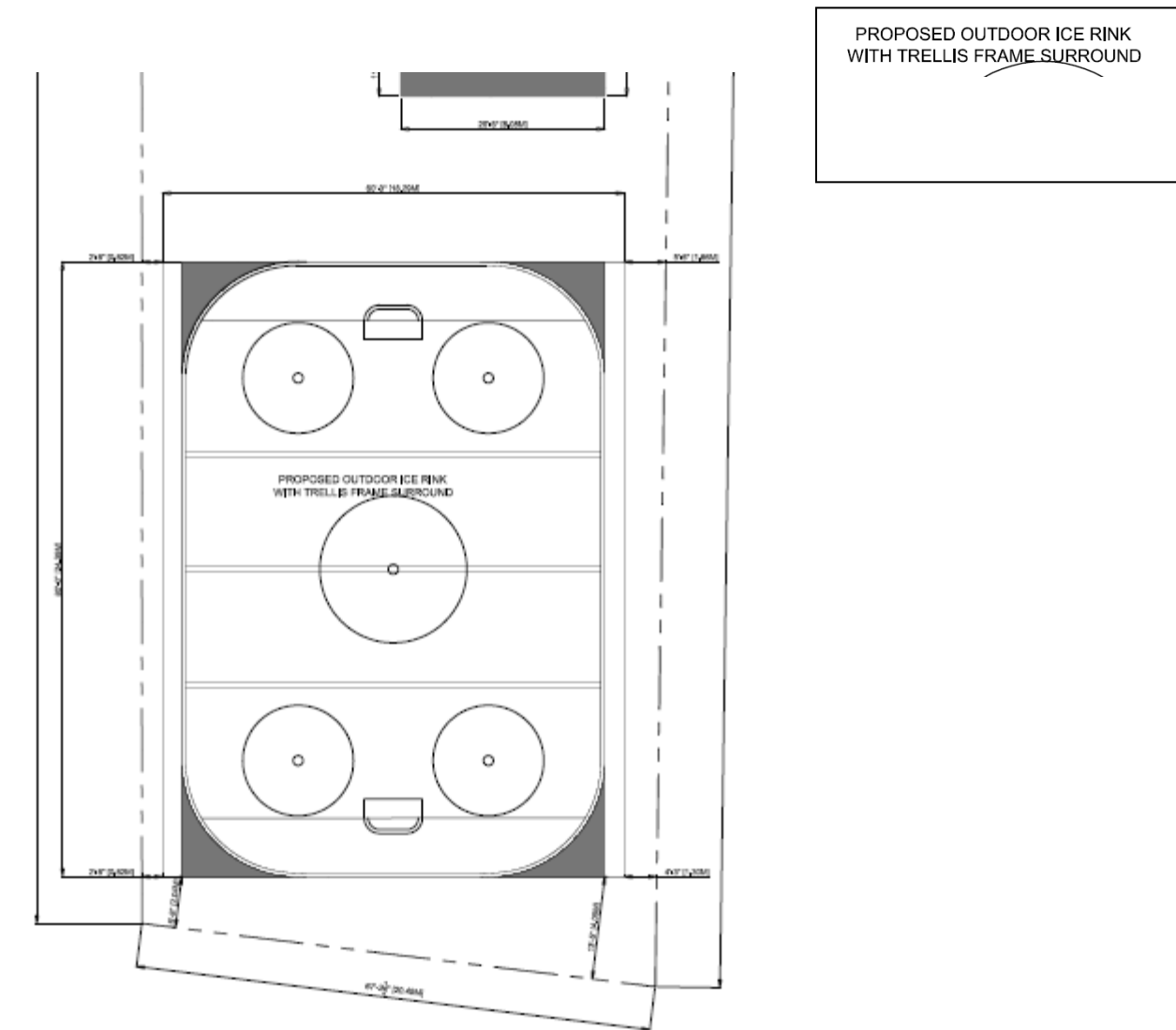

Statistics

Size of Rink 60' (18.29m) by 80' (24.38)

South Side setback of Rink from property boundary – 2'8" (0.82m)

North Side setback of Rink from property boundary – ranges from 5'5" (1.66m) to 4'3" (1.3m)

Rear Yard setback of Rink from property boundary – ranges from 6'8" (2.04m) to 13'5" (4.09m)

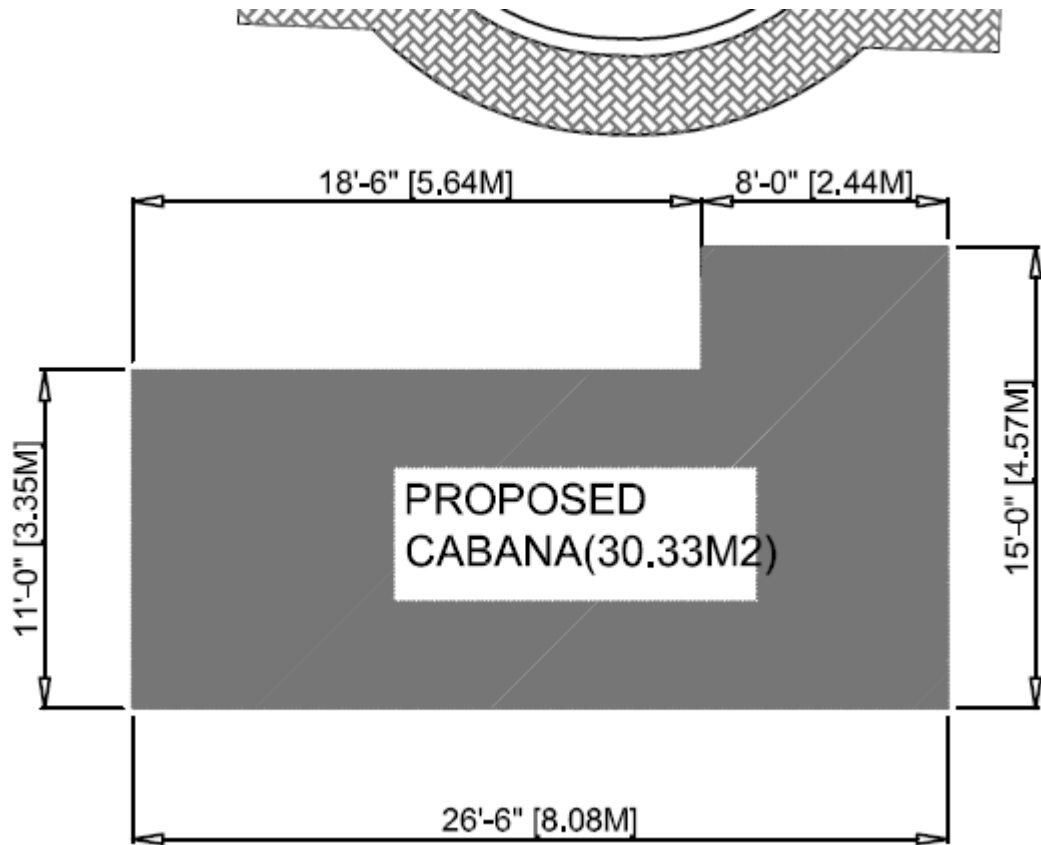

No elevation were provided.

Q:\Development\Heritage\PROPERTY\MAINSTU\233\Property alteration 2021\Staff Report\Attachment B
Plans.doc