



Alcohol and Gaming Commission of Ontario
Licensing and Registration
90 SHEPPARD AVE E SUITE 200
TORONTO ON M2N 0A4
Fax: 416-326-8711
Tel: 416-326-8700 or 1-800-522-2876 toll free in Ontario

The information requested below is required in support of all applications for a new Liquor Sales Licence or outdoor areas being added to an existing Liquor Sales Licence.

Section 1 - Application Details

Premises Name 2515014 Ontario Inc. o/a Markham Executive Golf Course	Premises Telephone Number 905-477-4653		
Contact Name Massimo Gargari	Contact's Telephone Number [REDACTED]	Email Address massimo@golfmarkham.com	
Address 7892 McCowan Road	City / Town Markham	Province / State ON	Postal Code L3P 3J3

Does the application for a Liquor Sales Licence include:

- ☒ Indoor areas
☒ Outdoor areas

Section 2 - Municipal Clerk's Official Notice of Application for a Liquor Sales Licence in your Municipality

Municipal Clerk:

Please confirm the "Wet/Damp/Dry" status below.

Name of village, town, township or city where taxes are paid: (If the area where the establishment is located was annexed or amalgamated, provide the name of the Village, Town, Township or City was known as)
[REDACTED]

Is the area where the establishment is located:

- ☒ Wet (for spirits, beer, wine) ☐ Damp (for beer and wine only) ☐ Dry

Note:

Specific concerns regarding zoning or non-compliance with by-laws must be clearly outlined in a separate submission or letter within 30 days of this notification.

Signature of Municipal Official	Title
Address of Municipal Office	Date YYYY MM DD



Liquor Licence Questionnaire

The Corporation of the City of Markham

Ward 8.

To evaluate your Liquor Licence Application, you are required to complete this Questionnaire.

Submit the all required documentation to the Clerk's Office by mail or in-person to the address below.

City of Markham
Clerk's Office
Legislative Services Department
101 Town Centre Boulevard
Markham, Ontario
L3R 9W3

Attention: Public Services Assistant

If you have any questions about this Questionnaire, please call 905-477-7000 ext. 2366.

Liquor Licence Questionnaire Checklist

The following items **must** be submitted with this completed Questionnaire to the Clerk's Office:

- ✓ Applicable fee;
- ✓ A sample menu; and,
- ✓ Copy of the floor plan showing the layout, areas that require licensing, seating arrangements, washrooms (show fixtures) and exits.

Applicant Contact Information

First Name Massimo		Last Name Gargari	
Street Number [REDACTED]	Street Name [REDACTED]		Suite/Unit Number
City [REDACTED]		Postal Code [REDACTED]	Province Ontario
Telephone Number [REDACTED]	Mobile Number [REDACTED]	Email massimo@golfmarkham.com	

Restaurant Information

Name of Restaurant Markham Executive Golf Course		
Street Number 7892	Street Name McCowan Road	Suite/Unit Number
City Markham	Postal Code L3P 3J3	Province On

Page 1 of 2

Rev. Jan/17

Information on this form is collected under the authority of Section 11 of the Municipal Act, 2001, S.O. 2001, c. 25, as amended and Section 12 of the Liquor Licence Act, R.S.O. 1990, Chapter L.19, as amended. The information you have provided will be used to contact you and process your Liquor Licence Application. If you have questions about this collection contact the Access & Privacy Manager, Legislative Services Development, 101 Town Centre Boulevard, Markham, Ontario, L3R 9W3, 905-477-5530.

What is the closest major intersection to the restaurant? McCowan Road and Highway #7	What is the distance between the restaurant and the closest residential area? (in kilometres) less than 1 kilometres
Does the restaurant have a valid Business Licence issued by the City of Markham? <div style="display: flex; justify-content: space-around; margin-top: 10px;"> <input checked="" type="radio"/> Yes <input type="radio"/> No </div> Business Licence Number: _____ <small>We recently applied for it (Food, Driving Range)</small>	Does the restaurant have a working Fire Alarm System? <div style="display: flex; justify-content: space-around; margin-top: 10px;"> <input checked="" type="radio"/> Yes <input type="radio"/> No </div> We have a Food Truck & Trailer
If no, please note that a Business Licence is required.	
Type of restaurant (select one) <div style="display: flex; justify-content: space-between; margin-top: 5px;"> <input type="checkbox"/> Family <input type="checkbox"/> Roadhouse <input checked="" type="checkbox"/> Sports Bar <input type="checkbox"/> Fine Dining <input checked="" type="checkbox"/> Take Out <input checked="" type="checkbox"/> Cafe </div>	
What, if any, entertainment or amusements will be provided in the restaurant? (select all that apply) <div style="display: flex; justify-content: space-between; margin-top: 5px;"> <input checked="" type="checkbox"/> Karaoke <input checked="" type="checkbox"/> Live Entertainment <input type="checkbox"/> Casino <input type="checkbox"/> Off-Track Betting <input type="checkbox"/> Arcade </div>	
Is the liquor licence application for an expansion of the existing operations? <div style="margin-top: 10px;"> <input type="radio"/> Yes <input checked="" type="radio"/> No </div>	
If yes, please provide the <u>current</u> existing maximum seating capacity: _____	
If no, please provide the <u>planned</u> existing maximum seating capacity: <u>118 + patio + endorsement</u>	
Location History	
Has a Building Permit been applied for or obtained for this location? <div style="margin-top: 10px;"> <input type="radio"/> Yes Building Permit Number: _____ <input checked="" type="radio"/> No </div>	
Was the location previously used as a restaurant? <input type="radio"/> Yes <input checked="" type="radio"/> No If no, a Building Permit is required. Contact Building Services at 905-477-7000 ext. 4870 for more information.	
If the location was previously used as a restaurant, has construction or alteration been proposed? <div style="margin-top: 10px;"> <input type="radio"/> Yes <input checked="" type="radio"/> No </div>	
If yes, please provide Alteration Permit Number: _____ We are running a food trailer outside of our main building	

Applicant's Signature

Date

Page 2 of 2

Rev. Jan/17

Information on this form is collected under the authority of Section 11 of the Municipal Act, 2001, S.O. 2001, c. 25, as amended and Section 12 of the Liquor Licence Act, R.S.O. 1990, Chapter L.19, as amended. The information you have provided will be used to contact you and process your Liquor Licence Application. If you have questions about this collection contact the Access & Privacy Manager, Legislative Services Development, 101 Town Centre Boulevard, Markham, Ontario, L3R 9W3, 905-477-5530.

MARKHAM EXECUTIVE GOLF COURSE

File #1023776

Area Number	Floor Level	Exact Location of Licensed /	Indoors or Outdoors	Total area (length x width) m2 or sq.ft.	Estimated capacity
1	Ground	Standing	Indoors	12 feet x 14 feet	19
2	Ground	Seating	Indoors	31 feet x 15 feet	54
3	Ground	Seating	Indoors	28 feet x 14 feet	45
4	Ground	Seating	Outdoors	120 feet x 80 feet	n/a
5	Ground	End Use	Outdoors	73 acres	n/a
TOTAL				118	

Sq/Ft	PPL
168	16%
465	45%
392	38%

1025 118.00

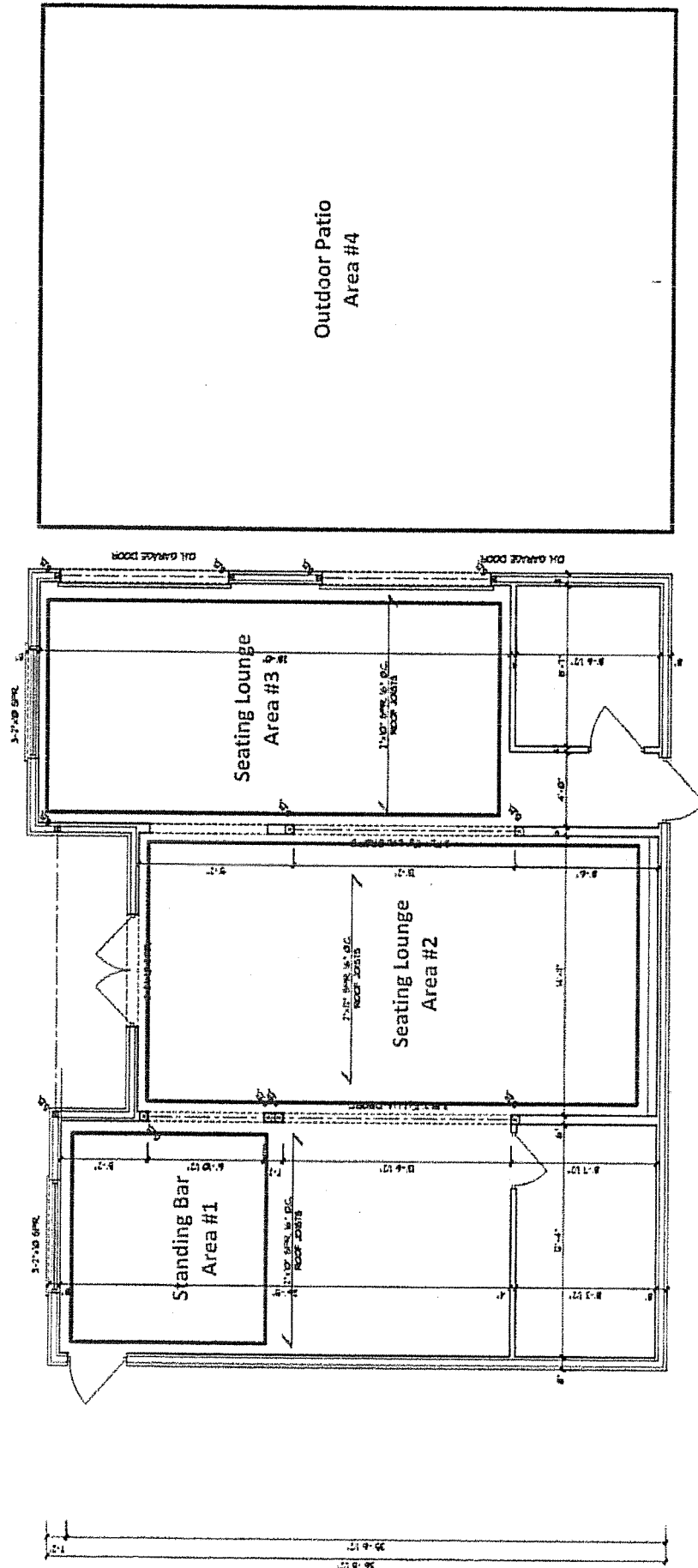
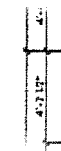

Golf Range / DOME

407 highway

407 highway

407 highway

Tennis Court

Basketball

Cricket
Baseball
Batting Cages

Soccer Field

50,000 sq/ft
Sports Dome
(Or Soccer Field & Batting Cages)

50 tee boxes
Driving Range

OUTDOOR COURT VESTIBULE

GARAGE

Clubhouse

80 x 40 Tent

Overflow Parking

EXISTING HOUSE

Existing Farm

Existing Golf Course

Existing Golf Course

Hydro Lines

Hydro Lines

Hydro Lines

Hydro Lines

Existing Parking

Washrooms

Endorsement Area #5

(Endorsement parking lot and roadways)

Existing Golf Course

Cemetery

KENNEDY AVE

MCCOWAN DR

CN RAIL

CN RAIL

CN RAIL



GROUND FLOOR PLAN

A-2

ALL FOR YOU

served with bread and pickles

JUMBO TENDERS

4 Jumbo tenders

\$12.00

THE SANDICHES

NASHVILLE HOT CHICKEN

Comeback Sauce + Pickles + American
Cheese + Buttered Buns

\$10.00

CRISPY CHICKEN DELUXE

Swiss Cheese + Pickles + Lettuce
+ Tomato + Beef bacon.

\$10.00

OG FRIED CHICKEN

Coleslaw + Pickles + American Cheese

\$10.00

THE SIDE CHICK

Tender + Comeback Sauce
+ Pickle + Slaw

\$10.00

THE BURGERS

CHEESE BURGER SINGLE

Single Patty + American Cheese + L&T
Shaved Onions + Pickles + Holy Sauce

\$7.00

THE HOLY BURGER

Double patty + American cheese
+ Shaved Onions + Pickles + Lettuce
+ Holy Sauce

\$10.00

THE TORONTO BURGER

Double patty + American cheese + L&T
+ Pickles + Topped with Pastrami
+ Signature Steak sauce

\$12.00

POUTINE IT!

THE HOLY POUTINE

Chilli Cheese Fries + topped Shredded
cheese + Comeback Sauce

\$8.00

MUMS BUTTER CHICKEN POUTINE

Signature Mums Butter Chicken + with
Fries + Cheese + Crispy Onions

\$8.00

CURDS N GRAVY

Quebec Cheese Curds + Chicken Gravy

\$7.00

HOLY STYLE FRIES

Fries + Cheese + Holy Sauce
+ Caramelized Onions

\$7.00

SIDES

FRIES

\$3.50

NEW SCHOOL SLAW

\$3.50

POTATO SALAD

\$3.50

EXTRAS

PICKLES

\$1.00

COMEBACK SAUCE

\$0.75

BURGER ADD ON'S

(L&T + Crispy Onions, Etc)

\$1.50

SATURDAY SPECIAL

BRISKETT POUTINE

Served On Saturdays Only

\$10.00



THE
HOLY
GRILL

HOW HOT CAN YOU HANDLE?

WARM KISS OF HEAT **MILD** BURN BABY BURN **MEDIUM** REALLY HOT **TOO HOTTEST** WE WARRNNNNNN YOU!

** Menu Subject to Change without notice, due to COVID19 **

