



Alcohol and Gaming Commission of Ontario
Licensing and Registration
90 SHEPPARD AVE E SUITE 200
TORONTO ON M2N 0A4
Fax: 416-326-8711
Tel: 416-326-8700 or 1-800-522-2876 toll free in Ontario

RECEIVED

JUL - 2 2020

CITY OF MARKHAM
CLERKS DEPT

WARD 2

Municipal Information

The information requested below is required in support of all applications for a new Liquor Sales Licence or outdoor areas being added to an existing Liquor Sales Licence.

Section 1 - Application Details

| | | | |
|---|--|--|-------------------------------|
| Premises Name <i>Hi Sakana Ramen</i> | Premises Telephone Number <i>(647) 994-0923</i> | | |
| Contact Name <i>David Liang</i> | Contact's Telephone Number <i>(99) 477-9113</i> | Email Address <i>dsliang@rogers.com</i> | |
| Address <i>735 Markham St. #B1-7</i> | City / Town <i>Markham</i> | Province / State <i>ON</i> | Postal Code <i>L6C 0G6</i> |

Does the application for a Liquor Sales Licence include:

- ☒ Indoor areas
☐ Outdoor areas

Section 2 - Municipal Clerk's Official Notice of Application for a Liquor Sales Licence in your Municipality

Municipal Clerk:

Please confirm the "Wet/Damp/Dry" status below.

Name of village, town, township or city where taxes are paid: (If the area where the establishment is located was annexed or amalgamated, provide the name of the Village, Town, Township or City was known as)

Is the area where the establishment is located:

- ☐ Wet (for spirits, beer, wine) ☐ Damp (for beer and wine only) ☐ Dry

Note:

Specific concerns regarding zoning or non-compliance with by-laws must be clearly outlined in a separate submission or letter within 30 days of this notification.

| | |
|---------------------------------|--------------------|
| Signature of Municipal Official | Title |
| Address of Municipal Office | Date YYYY MM DD |



Liquor Licence Questionnaire

The Corporation of the City of Markham

To evaluate your Liquor Licence Application, you are required to complete this Questionnaire.

Submit the all required documentation to the Clerk's Office by mail or in-person to the address below.

City of Markham
Clerk's Office
Legislative Services Department
101 Town Centre Boulevard
Markham, Ontario
L3R 9W3

Attention: Public Services Assistant

If you have any questions about this Questionnaire, please call 905-477-7000 ext. 2366.

Liquor Licence Questionnaire Checklist

The following items **must** be submitted with this completed Questionnaire to the Clerk's Office:

- ✓ Applicable fee;
- ✓ A sample menu; and
- ✓ Copy of the floor plan showing the layout, areas that require licensing, seating arrangements, washrooms (show fixtures) and exits.

Applicant Contact Information

| | | | |
|----------------------------------|------------------------------------|------------------------------|--------------------------|
| First Name David | | Last Name Liang | |
| Street Number 3636 | Street Name Steeles Avenue East | | Suite/Unit Number 311 |
| City Markham | | Postal Code L3R 1K9 | Province Ontario |
| Telephone Number 905-477-9113 | Mobile Number 647-668-8829 | Email dscliang@rogers.com | |

Restaurant Information

| | | | |
|--|--------------------------------|------------------------|---------------------------|
| Name of Restaurant Koi Sakana Ramen | | | |
| Street Number 735 | Street Name Markland Street | | Suite/Unit Number B1-7 |
| City Markham | | Postal Code L6C 0G6 | Province Ontario |

| | |
|---|--|
| What is the closest major intersection to the restaurant? Major MacKenzie Drive East and Woodbine Avenue | What is the distance between the restaurant and the closest residential area? (in kilometres) Less than 1 Km |
| Does the restaurant have a valid Business Licence issued by the City of Markham? <input type="radio"/> Yes <input checked="" type="radio"/> No Business Licence Number: _____ If no, please note that a Business Licence is required. | Does the restaurant have a working Fire Alarm System? <input checked="" type="radio"/> Yes <input type="radio"/> No |
| Type of restaurant (select one) <input checked="" type="checkbox"/> Family <input type="checkbox"/> Roadhouse <input type="checkbox"/> Sports Bar <input type="checkbox"/> Fine Dining <input type="checkbox"/> Take Out <input type="checkbox"/> Cafe | |
| What, if any, entertainment or amusements will be provided in the restaurant? (select all that apply) <input type="checkbox"/> Karaoke <input type="checkbox"/> Live Entertainment <input type="checkbox"/> Casino <input type="checkbox"/> Off-Track Betting <input type="checkbox"/> Arcade | |
| Is the liquor licence application for an expansion of the existing operations? <input type="radio"/> Yes <input checked="" type="radio"/> No If yes, please provide the <u>current</u> existing maximum seating capacity: _____ If no, please provide the <u>planned</u> existing maximum seating capacity: <u>28</u> | |
| Location History | |
| Has a Building Permit been applied for or obtained for this location? <input checked="" type="radio"/> Yes Building Permit Number: <u>20 106918 000 00 AL</u> <input type="radio"/> No | |
| Was the location previously used as a restaurant? <input type="radio"/> Yes <input checked="" type="radio"/> No If no, a Building Permit is required. Contact Building Services at 905-477-7000 ext. 4870 for more information. | |
| If the location was previously used as a restaurant, has construction or alteration been proposed? <input type="radio"/> Yes <input type="radio"/> No <u>N/A</u> If yes, please provide Alteration Permit Number: _____ | |

[Signature]
Applicant's Signature

2020/07/03
Date

Ramen

A1. 北海道牛奶濃豚骨湯拉麵  +  =  \$12.99  No.1

Hokkaido ramen (Milky tonkotsu soup base)
BBQ pork x2, egg, green onion, black fungus, corn, fishcake

A2. 極上北海牛奶濃豚骨湯拉麵  +  =  \$15.99

Deluxe Hokkaido ramen
BBQ pork x2, tender rib, egg, green onion, black fungus, corn, fishcake

A3. 濃豚骨湯拉麵  \$11.99

Tonkotsu ramen (Richer and saltier) (湯味較濃和較鹹)
BBQ pork x2, egg, green onion, black fungus, corn, fishcake

A4. 自家濃豚骨湯拉麵  \$11.99

House tonkotsu ramen
BBQ pork x2, egg, green onion, black fungus, corn, fishcake

A5. 極上自家濃豚骨湯拉麵 \$14.99

Deluxe house tonkotsu ramen
BBQ pork x2, tender rib, egg, green onion, black fungus, corn, fishcake

A6. 豚軟骨拉麵  \$11.99

Pork cartilage ramen
(可選自家濃豚骨湯或鹽味清湯)
Choice house tonkotsu soup or shio clear soup
Tender rib, egg, green onion, wakame, corn, fishcake

A7. 醬油湯拉麵 \$10.99

Shoyu ramen
BBQ pork x2, wakame, egg, corn, green onion

A8. 煙肉芝士拉麵  +  \$12.99

Bacon and cheese ramen
Bacon, cheese, BBQ pork x1, corn, egg, green onion

A9. 雜菜自家濃豚骨湯拉麵 \$10.99

Vegetables house tonkotsu ramen
Egg, green onion, black fungus, corn, fishcake, wakame

A10. 雜菜雜菜湯拉麵 \$10.99

Vegetable ramen (Veggie soup base)
Egg, green onion, black fungus, corn, fishcake, wakame

A11. 味噌豚舌拉麵 \$11.99

Miso pork tongue ramen
Pork tongue, egg, green onion, wakame, corn, fishcake

Ramen and rice

A12. 地獄拉麵 (可選: 1級辣 🌶️ 2級辣 🌶️🌶️ 3級辣 🌶️🌶️🌶️) \$11.99

Spicy ramen (spicy level 1 🌶️ 2 🌶️🌶️ 3 🌶️🌶️🌶️)

BBQ pork x1.5, corn, green onion, egg, baby shrimp

A13. 極上地獄拉麵 (可選: 1級辣 🌶️ 2級辣 🌶️🌶️ 3級辣 🌶️🌶️🌶️) \$15.99

Deluxe spicy ramen (spicy level 1 🌶️ 2 🌶️🌶️ 3 🌶️🌶️🌶️)

BBQ pork x2, tender rib, egg, green onion, corn, baby shrimp

A14. 咖喱吉列豬扒拉麵 \$16.99

Pork cutlet curry ramen

Pork cutlet, black fungus, green onion, corn, fishcake, egg

A15. 咖喱海鮮拉麵 \$16.99

Seafood curry ramen

Scallop, shrimp, squid, mussel, corn, green onion, crab, fishcake

A16. 日式炒麵 \$11.99

Yaki soba

Vegetable, bacon, bonito

A17. 牛肉湯烏冬 \$12.99

Beef Udon noodle soup

A18. 日式鰻魚飯 \$16.99

Unagi Don (BBQ Eel with rice)

A19. 咖喱吉列豬扒飯 \$16.99

Pork cutlet curry rice

追加 Add toppings

淨麵 noodle (noodle on the side, not included soup)

叉燒 BBQ pork (each)

軟骨 Pork cartilage (per order)

豚舌 pork tongue (per order)

蛋 egg (each)

粟米。海帶。蔥。木耳。

Corn. Wakame. Green onion. Black fungus (each)

魚餅 fish (each)

芝士 cheese (per order)

Appetizers

B1. 燒魷魚筒 

Ika yaki \$15.99

B3. 日式煎餃子 

Gyoza \$4.50

B5. 日式炒帶子

Pan-fried scallop
\$15.99

B7. 燒鰻魚

Unagi \$8.99

B9. 炸獅子狗

Fried fish roll
\$3.99

B11. 串燒雞

Yakitori \$4.99

(BBQ chicken on skewer)(Fried chicken ball)

B2. 章魚小丸子

Tako yaki \$4.99

B4. 吉列豬扒

Pork cutlet \$6.99

B6. 牛舌味噌煮

miso OX tongue
\$7.99

B8. 日式炒雜菜

Pan-fried veggies
\$8.99

B10. 炸花枝丸 

Fried squid ball
\$4.99

B12. 炸雞粒

Chicken karate \$5.99

Drink menu

Alcohol :

Japanese beer:

- C1. Asahi (500 ml) \$ 7.50
- C2. Kirin Ichiban (500 ml) \$ 7.50
- ~~C3. Hitagata BLACK beer (210ml)~~

Sake :

- C4. Ozeki One Cup Daiginjo premium (180 ml) 15.8% alc./vol \$ 14.99
- C5. one cup junmai nigeri (180 ml) 10.6% alc./vol \$ 15.99
- C6. Sparkling jelly sake-yuzu (180 ml) 5.6% alc./vol \$ 12.99
- C7. Sparkling jelly sake-peach (180 ml) 5.6% alc./vol \$ 12.99
- C8. Ozeki sake dry (180ml) 14.5% alc./vol \$ 12.99

Beverage:

- C9. Coke, Diet-coke, sprite, c-plus \$ 2.00
- C10. Perrier (pamplemousse rose or original flavor) \$ 2.00
- C11. Ice tea \$ 2.00
- C12. Arizona \$ 3.75
- C13. Golden oolong tea (no sugar) \$ 4.75
- C14. Ramune drink (波子汽水) (grape or original flavor) \$ 4.75
- C15. UCC Coffee (kona or original flavor) \$ 4.75

House hot sake:

- ~~C16. Hot sake (small) 6oz~~
- ~~C17. Hot sake (large) 12oz~~

ADDRESS:
UNIT B1-7, 735 MARKLAND ST.,
MARKHAM, ON

FLOOR PLAN:
SCALE: 1/8" = 1'-0"

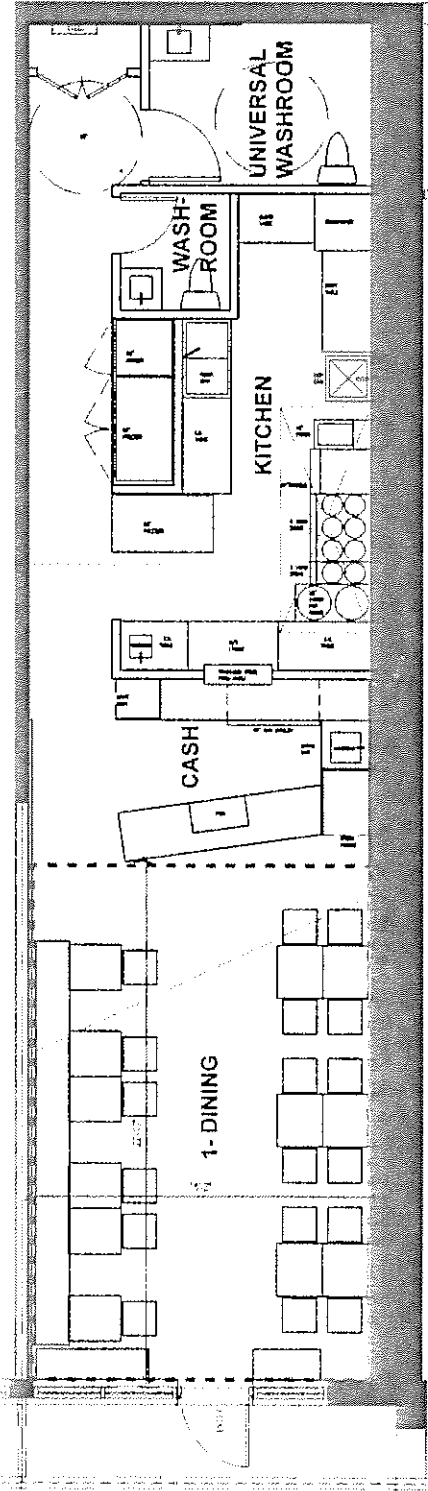

| AREA | FLOOR LEVEL | LOCATION | INDOOR/ OUTDOOR | TOTAL AREA | ESTIMATED CAPACITY |
|------|-------------|----------|-----------------|-------------|--------------------|
| 1 | GROUND | DINING | INDOOR | 343 SQ. FT. | 28 |