



Liquor Licence Questionnaire

The Corporation of the City of Markham

To evaluate your Liquor Licence Application, you are required to complete this Questionnaire.

Submit the all required documentation to the Clerk's Office by mail or in-person to the address below.

City of Markham
Clerk's Office
Legislative Services Department
101 Town Centre Boulevard
Markham, Ontario
L3R 9W3

Attention: Public Services Assistant

If you have any questions about this Questionnaire, please call 905-477-7000 ext. 2366.

Liquor Licence Questionnaire Checklist

The following items must be submitted with this completed Questionnaire to the Clerk's Office:

- ✓ Applicable fee;
- ✓ A sample menu; and,
- ✓ Copy of the floor plan showing the layout, areas that require licensing, seating arrangements, washrooms (show fixtures) and exits.

Applicant Contact Information

First Name Oliver		Last Name Sun	
Street Number 10950	Street Name Woodbine Ave		Suite/Unit Number 1
City Markham		Postal Code L6C 3L4	Province ON
Telephone Number 647-205-6125	Mobile Number 647-556-1888	Email prcsun018@yahoo.ca	

Restaurant Information

Name of Restaurant 54 Brewing Co.			
Street Number 10950	Street Name Woodbine Ave		Suite/Unit Number 1
City Markham		Postal Code L6C 3L4	Province ON

Page 1 of 2

Rev. Jan/17

Information on this form is collected under the authority of Section 11 of the Municipal Act, 2001, S.O. 2001, c. 25, as amended and Section 12 of the Liquor Licence Act, R.S.O. 1990, Chapter L.19, as amended. The information you have provided will be used to contact you and process your Liquor Licence Application. If you have questions about this collection contact the Access & Privacy Manager, Legislative Services Development, 101 Town Centre Boulevard, Markham, Ontario, L3R 9W3, 905-477-5530.

What is the closest major intersection to the restaurant? Eglin Mills/Woodbine	What is the distance between the restaurant and the closest residential area? (in kilometres) 0.5
Does the restaurant have a valid Business Licence issued by the City of Markham? <input checked="" type="radio"/> Yes <input type="radio"/> No Business Licence Number: 25 113841 EE	Does the restaurant have a working Fire Alarm System? <input checked="" type="radio"/> Yes <input type="radio"/> No
If no, please note that a Business Licence is required.	
Type of restaurant (select one) <i>Just a Brewery with a Sampling area</i> <input type="checkbox"/> Family <input type="checkbox"/> Roadhouse <input type="checkbox"/> Sports Bar <input type="checkbox"/> Fine Dining <input type="checkbox"/> Take Out <input type="checkbox"/> Cafe	
What, if any, entertainment or amusements will be provided in the restaurant? (select all that apply) <input type="checkbox"/> Karaoke <input type="checkbox"/> Live Entertainment <input type="checkbox"/> Casino <input type="checkbox"/> Off-Track Betting <input type="checkbox"/> Arcade	
Is the liquor licence application for an expansion of the existing operations? <input type="radio"/> Yes <input checked="" type="radio"/> No	
If yes, please provide the <u>current</u> existing maximum seating capacity: _____	
If no, please provide the <u>planned</u> existing maximum seating capacity: <u>9</u>	
Location History	
Has a Building Permit been applied for or obtained for this location? <input checked="" type="radio"/> Yes Building Permit Number: <u>22 261521 000 00 AL</u> <input type="radio"/> No	
Was the location previously used as a restaurant? <input type="radio"/> Yes <input checked="" type="radio"/> No If no, a Building Permit is required. Contact Building Services at 905-477-7000 ext. 4870 for more information.	
If the location was previously used as a restaurant, has construction or alteration been proposed? <input type="radio"/> Yes <input checked="" type="radio"/> No	
If yes, please provide Alteration Permit Number: _____	

e451386d-201e-4457-8f2
2-3aba4bf19fc2

Digitally signed by
e451386d-201e-4457-8f22-3aba4bf19fc2
Date: 2025.04.16 20:48:12 -04'00'

Applicant's Signature

APR 16, 2025

Date

Page 2 of 2

Rev. Jan/17

Information on this form is collected under the authority of Section 11 of the Municipal Act, 2001, S.O. 2001, c. 25, as amended and Section 12 of the Liquor Licence Act, R.S.O. 1990, Chapter L.19, as amended. The information you have provided will be used to contact you and process your Liquor Licence Application. If you have questions about this collection contact the Access & Privacy Manager, Legislative Services Development, 101 Town Centre Boulevard, Markham, Ontario, L3R 9W3, 905-477-5530.

0.9

2

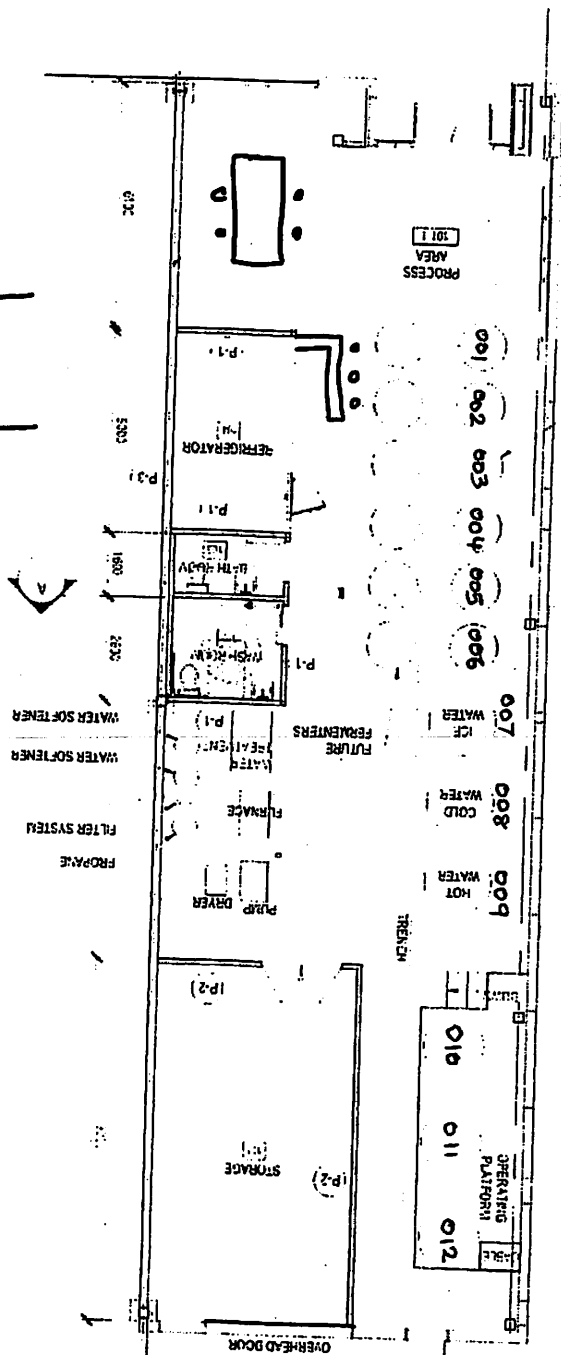

GROUND FLOOR PLAN
SCALE 1/100

Bar/
Taping
Table/
Chairs

612

530

180

2230

WATER SOFTENER

WATER SOFTENER

FILTER SYSTEM

PROPANE

(P-2)

STORAGE

OVERHEAD DOOR

510

100

PROCESS
AREA
101.1

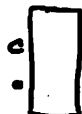

001

002

003

004

005

006

007

008

009

010

011

012

013

014

015

016

017

018

019

020

021

022

023

PERMANENTS

15210

B

C

A